

STATE OF MINNESOTA  
SPECIAL REDISTRICTING PANEL  
A11-152

OFFICE OF  
APPELLATE COURTS

NOV 18 2011

**FILED**

---

Sara Hippert, Dave Greer, Linda Markowitz,  
Dee Dee Larson, Ben Maas, Gregg Peppin,  
Randy Penrod and Charles Roulet, individually  
and on behalf of all citizens and voting  
residents of Minnesota similarly situated,

Plaintiffs,

Kenneth Martin, Lynn Wilson, Timothy O'Brien,  
Irene Peralez, Josie Johnson, Jane Krentz, Mark  
Altenburg, and Debra Hasskamp, individually and on  
behalf of all citizens of Minnesota similarly situated,

Plaintiff-Intervenors,

Audrey Britton, David Bly, Cary Coop,  
and John McIntosh, individually and on behalf  
of all citizens of Minnesota similarly situated,

Plaintiff-Intervenors,

vs.

Mark Ritchie, Secretary of State of Minnesota; and  
Robert Hiivala, Wright County Auditor, individually and  
on behalf of all Minnesota county chief election officers,

Defendants.

---

Dated: November 18, 2011

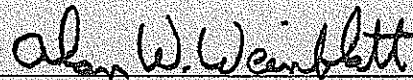

Alan W. Weinblatt (#115332)

Jay Benanav (#0006518)

Jane L. Prince (#0388669)

WEINBLATT & GAYLORD, PLC

111 East Kellogg Boulevard, Suite 300

St. Paul, MN 55101

Telephone: (651) 292-8770

Facsimile: (651) 223-8282

[alan@weglaw.com](mailto:alan@weglaw.com)

*Attorneys for Intervenors Britton, et al.*

**BRITTON et al PLAINTIFFS' CONGRESSIONAL PLAN REPORTS**

**TABLE OF CONTENTS**

Congressional Plan Reports

Population Summary and Deviation Report	C1
Plan Components Report	C2
Contiguity Report	C3
Compactness Report	C4
Political Subdivision Splits Report	C5
Minority Report – Voting Age Population	C6
Description of Districts	C7

District Maps



## Population Summary Report

---

Overall Range:			0.00 Percent	2 Persons
Largest District:	662,992	Deviation:	0.00 Percent	1 Persons
Smallest District:	662,990	Deviation:	0.00 Percent	-1 Persons
		Mean Deviation:	0.00 Percent	0.63 Persons
		Standard Deviation:	1	0.74 Persons
Ideal District:	662,991			

---

District	Population	Deviation	% Devn.
1	662,990	-1	0.00
2	662,991	0	0.00
3	662,991	0	0.00
4	662,992	1	0.00
5	662,990	-1	0.00
6	662,990	-1	0.00
7	662,990	-1	0.00
8	662,991	0	0.00

---

**State Total:** 5,303,925

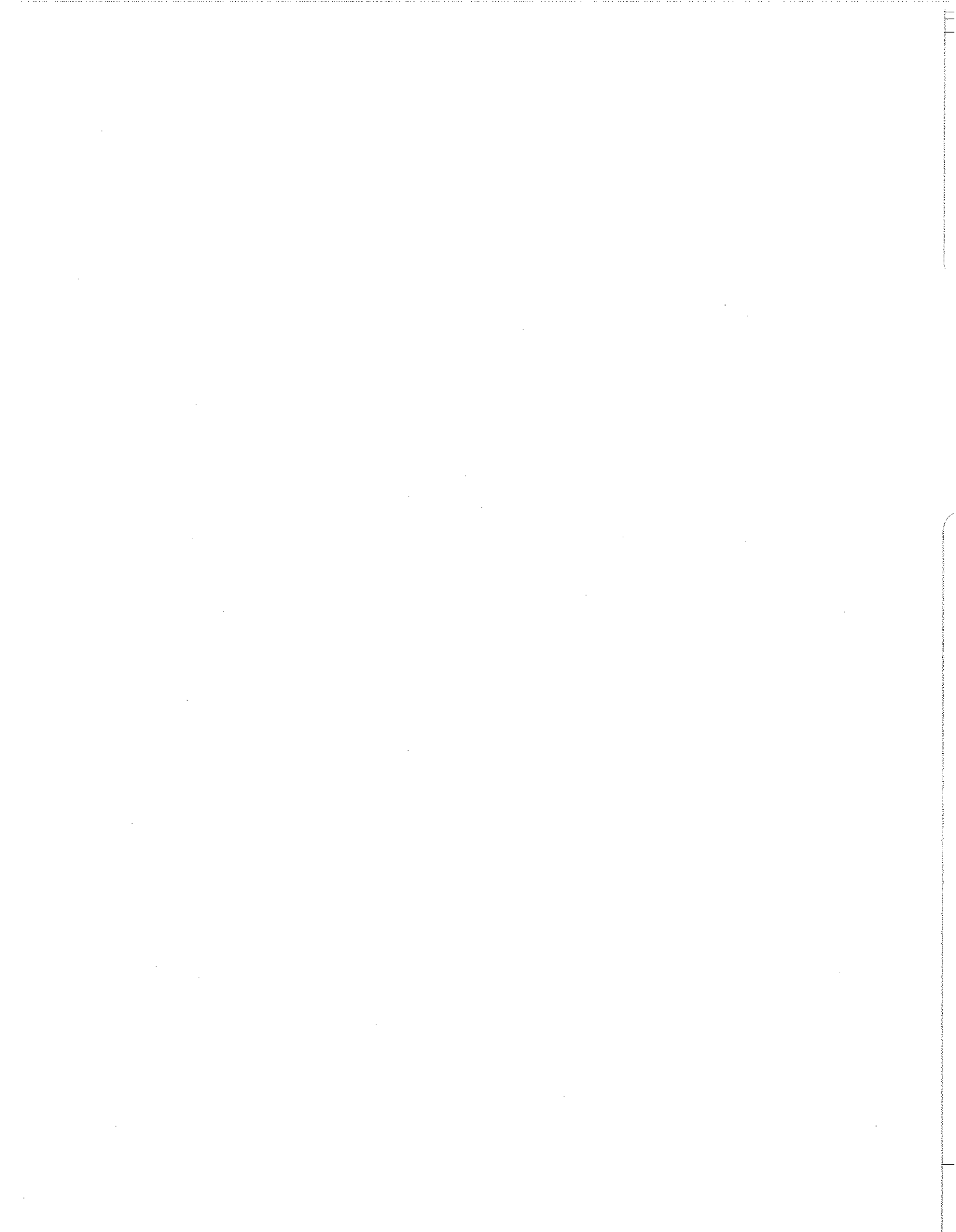

Plan: Britton et al Congressional Plan  
 Plan Type: Congressional  
 Administrator: Alan Weinblatt  
 User:

## Plan Components Report

Tuesday, November 15, 2011

11:49 AM

POPULATION	
<b>District 1</b>	
Blue Earth MN County	64,013
Dakota MN County	
MCD: Northfield City	1,147
<b>Dakota MN County Subtotal</b>	<b>1,147</b>
Dodge MN County	20,087
Faribault MN County	14,553
Fillmore MN County	20,866
Freeborn MN County	31,255
Goodhue MN County	46,183
Houston MN County	19,027
Le Sueur MN County	
MCD: Cleveland City	719
MCD: Cleveland Township	658
MCD: Cordova Township	471
MCD: Derrynane Township	508
MCD: Elysian City	650
MCD: Elysian Township	1,046
MCD: Heidelberg City	122
MCD: Kasota City	675
MCD: Kasota Township	1,581
MCD: Kilkenny City	134
MCD: Kilkenny Township	404
MCD: Lanesburgh Township	2,035
MCD: Le Center City	2,499
MCD: Le Sueur City	4,048
MCD: Lexington Township	707
MCD: Mankato City	4
MCD: Montgomery City	2,956
MCD: Montgomery Township	665
MCD: New Prague City ( <i>part</i> )	857
MCD: Ottawa Township	283
MCD: Sharon Township	636
MCD: Tyrone Township	562
MCD: Washington Township	715
MCD: Waterville City	1,868
MCD: Waterville Township	716
<b>Le Sueur MN County Subtotal</b>	<b>25,519</b>
Mower MN County	39,163

Plan:	Britton et al Congressional Plan	Administrator:	Alan Weinblatt
Type:	Congressional	User:	

**POPULATION**

**District 1 (continued)**

Nicollet MN County	32,727
Olmsted MN County	144,248
Rice MN County	64,142
Steele MN County	36,576
Wabasha MN County	21,676
Waseca MN County	19,136
Watonwan MN County	11,211
Winona MN County	51,461
<b>District 1 Subtotal</b>	<b>662,990</b>

**District 2**

Carver MN County	91,042
Dakota MN County	
MCD: Apple Valley City	49,084
MCD: Burnsville City	60,306
MCD: Castle Rock Township	1,342
MCD: Coates City	161
MCD: Douglas Township	716
MCD: Eagan City (part)	1,003
MCD: Empire Township	2,444
MCD: Eureka Township	1,426
MCD: Farmington City	21,086
MCD: Greenvale Township	803
MCD: Hampton City	689
MCD: Hampton Township	903
MCD: Hastings City	22,172
MCD: Lakeville City	55,954
MCD: Marshan Township	1,106
MCD: Miesville City	125
MCD: New Trier City	112
MCD: Nininger Township	950
MCD: Randolph City	436
MCD: Randolph Township	659
MCD: Ravenna Township	2,336
MCD: Rosemount City	21,874
MCD: Sciota Township	414
MCD: Vermillion City	419
MCD: Vermillion Township	1,192
MCD: Waterford Township	497
<b>Dakota MN County Subtotal</b>	<b>248,209</b>
Hennepin MN County	
MCD: Chanhassen City	0
<b>Hennepin MN County Subtotal</b>	<b>0</b>
Kandiyohi MN County	42,239
Le Sueur MN County	
MCD: New Prague City (part)	2,184

**POPULATION**

**District 2 (continued)**

<b>Le Sueur MN County Subtotal</b>	<b>2,184</b>
McLeod MN County	36,651
Meeker MN County	23,300
Renville MN County	15,730
Scott MN County	129,928
Sibley MN County	15,226
Wright MN County	
MCD: Albion Township	1,255
MCD: Annandale City	3,228
MCD: Buffalo City	15,453
MCD: Buffalo Township	1,804
MCD: Chatham Township	1,302
MCD: Cokato City	2,694
MCD: Cokato Township	1,311
MCD: Corinna Township	2,322
MCD: Delano City	5,464
MCD: Franklin Township	2,760
MCD: French Lake Township	1,172
MCD: Howard Lake City	1,962
MCD: Maple Lake City	2,059
MCD: Maple Lake Township	2,048
MCD: Marysville Township	2,147
MCD: Middleville Township	937
MCD: Montrose City	2,847
MCD: Rockford Township <i>(part)</i>	1,564
MCD: South Haven City	187
MCD: Southside Township	1,521
MCD: St. Michael City <i>(part)</i>	15
MCD: Stockholm Township	959
MCD: Victor Township	1,032
MCD: Waverly City	1,357
MCD: Woodland Township	1,082
<b>Wright MN County Subtotal</b>	<b>58,482</b>
<b>District 2 Subtotal</b>	<b>662,991</b>

**District 3**

Anoka MN County	
MCD: Andover City <i>(part)</i>	10,155
MCD: Anoka City	17,142
MCD: Coon Rapids City	61,476
MCD: Nowthen City <i>(part)</i>	53
MCD: Ramsey City	23,668
<b>Anoka MN County Subtotal</b>	<b>112,494</b>
Hennepin MN County	
MCD: Brooklyn Center City	30,104
MCD: Brooklyn Park City	75,781
MCD: Champlin City	23,089
MCD: Corcoran City	5,379



Plan: Britton et al Congressional Plan  
Type: Congressional

Administrator: Alan Weinblatt  
User:

**POPULATION**

**District 3 (continued)**

Hennepin MN County (continued)

MCD: Dayton City	4,617
MCD: Deephaven City	3,642
MCD: Eden Prairie City	60,797
MCD: Edina City (part)	7,863
MCD: Excelsior City	2,188
MCD: Greenfield City	2,777
MCD: Greenwood City	688
MCD: Hanover City (2705326990)	609
MCD: Hassan Township	2,600
MCD: Hopkins City	17,591
MCD: Independence City	3,504
MCD: Long Lake City	1,768
MCD: Loretto City	650
MCD: Maple Grove City	61,567
MCD: Maple Plain City	1,768
MCD: Medicine Lake City	371
MCD: Medina City	4,892
MCD: Minnetonka Beach City	539
MCD: Minnetonka City	49,734
MCD: Minnetrista City	6,384
MCD: Mound City	9,052
MCD: Orono City	7,437
MCD: Osseo City	2,430
MCD: Plymouth City	70,576
MCD: Rockford City (2705355006)	426
MCD: Rogers City	8,597
MCD: Shorewood City	7,307
MCD: Spring Park City	1,669
MCD: St. Bonifacius City	2,283
MCD: Tonka Bay City	1,475
MCD: Wayzata City	3,688
MCD: Woodland City	437

**Hennepin MN County Subtotal** **484,279**

Wright MN County

MCD: Albertville	7,044
MCD: Clearwater City	1,735
MCD: Clearwater Township	1,306
MCD: Dayton City (2717115022)	54
MCD: Hanover City	2,329
MCD: Monticello City	12,759
MCD: Monticello Township	3,181
MCD: Otsego City	13,571
MCD: Rockford City	3,890
MCD: Rockford Township (part)	1,630
MCD: Silver Creek Township	2,335
MCD: St. Michael City (part)	16,384

**Wright MN County Subtotal** **66,218**

**District 3 Subtotal** **662,991**

**District 4**

Plan:	Britton et al Congressional Plan	Administrator:	Alan Weinblatt
Type:	Congressional	User:	

**POPULATION**

**District 4 (continued)**

Dakota MN County	
MCD: Eagan City ( <i>part</i> )	63,203
MCD: Inver Grove Heights City	33,880
MCD: Lilydale City	623
MCD: Mendota City	198
MCD: Mendota Heights City	11,071
MCD: South St. Paul City	20,160
MCD: Sunfish Lake City	521
MCD: West St. Paul City	19,540
<b>Dakota MN County Subtotal</b>	<b>149,196</b>
Hennepin MN County	
MCD: St. Anthony City	5,156
<b>Hennepin MN County Subtotal</b>	<b>5,156</b>
Ramsey MN County	508,640
<b>District 4 Subtotal</b>	<b>662,992</b>

**District 5**

Hennepin MN County	
MCD: Bloomington City	82,893
MCD: Crystal City	22,151
MCD: Edina City ( <i>part</i> )	40,078
MCD: Fort Snelling Unorganized	149
MCD: Golden Valley City	20,371
MCD: Minneapolis City	382,578
MCD: New Hope City	20,339
MCD: Richfield City	35,228
MCD: Robbinsdale City	13,953
MCD: St. Louis Park City	45,250
<b>Hennepin MN County Subtotal</b>	<b>662,990</b>
<b>District 5 Subtotal</b>	<b>662,990</b>

**District 6**

Anoka MN County	
MCD: Andover City ( <i>part</i> )	20,443
MCD: Bethel City	466
MCD: Blaine City	57,186
MCD: Centerville City	3,792
MCD: Circle Pines City	4,918
MCD: Columbia Heights City	19,496
MCD: Columbus Township	3,914
MCD: East Bethel City	11,626
MCD: Fridley City	27,208
MCD: Ham Lake City	15,296
MCD: Hilltop City	744
MCD: Lexington City	2,049
MCD: Lino Lakes City	20,216
MCD: Linwood Township	5,123
MCD: Nowthen City ( <i>part</i> )	4,390
MCD: Oak Grove City	8,031
MCD: Spring Lake Park City	6,234

**POPULATION**

**District 6 (continued)**

Anoka MN County (continued)	
MCD: St. Francis City	7,218
<b>Anoka MN County Subtotal</b>	<b>218,350</b>
<hr/>	
Benton MN County	38,451
Sherburne MN County	88,499
Stearns MN County	
MCD: Le Sauk Township	1,766
MCD: Sartell City	13,630
MCD: St. Cloud City	52,661
MCD: St. Joseph City <i>(part)</i>	3,704
MCD: St. Joseph Township <i>(part)</i>	1,078
MCD: Waite Park City	6,715
<b>Stearns MN County Subtotal</b>	<b>79,554</b>
<hr/>	
Washington MN County	238,136
<b>District 6 Subtotal</b>	<b>662,990</b>

**District 7**

Becker MN County	32,504
Beltrami MN County	
MCD: Alaska Township	217
MCD: Bemidji City	13,431
MCD: Bemidji Township	3,134
MCD: Benville Township	86
MCD: Buzzle Township	310
MCD: Eckles Township	1,516
MCD: Grant Valley Township	2,029
MCD: Hamre Township	13
MCD: Jones Township	277
MCD: Lammers Township	592
MCD: Lee Township	51
MCD: Liberty Township	730
MCD: Lower Red Lake Unorganized	5,803
MCD: Maple Ridge Township	104
MCD: Minnie Township	26
MCD: North Beltrami Unorg	35
MCD: Northern Township <i>(part)</i>	1,044
MCD: Roosevelt Township	225
MCD: Solway City	96
MCD: Spruce Grove Township	55
MCD: Steenerson Township	23
MCD: Wilton City	204
<b>Beltrami MN County Subtotal</b>	<b>30,001</b>
<hr/>	
Big Stone MN County	5,269
Brown MN County	25,893
Chippewa MN County	12,441
Clay MN County	58,999
Clearwater MN County	8,695

Plan: Britton et al Congressional Plan  
Type: Congressional

Administrator: Alan Weinblatt  
User:

**POPULATION**

**District 7 (continued)**

Cottonwood MN County	11,687
Douglas MN County	36,009
Grant MN County	6,018
Jackson MN County	10,266
Kittson MN County	4,552
Lac qui Parle MN County	7,259
Lake of the Woods MN County	4,045
Lincoln MN County	5,896
Lyon MN County	25,857
Mahnomen MN County	5,413
Marshall MN County	9,439
Martin MN County	20,840
Murray MN County	8,725
Nobles MN County	21,378
Norman MN County	6,852
Otter Tail MN County	57,303
Pennington MN County	13,930
Pipestone MN County	9,596
Polk MN County	31,600
Pope MN County	10,995
Red Lake MN County	4,089
Redwood MN County	16,059
Rock MN County	9,687
Roseau MN County	15,629
Stearns MN County	
MCD: Albany City	2,561
MCD: Albany Township	980
MCD: Ashley Township	262
MCD: Avon City	1,396
MCD: Avon Township	2,294
MCD: Belgrade City	740
MCD: Brockway Township	2,702
MCD: Brooten City	743
MCD: Clearwater City	0
MCD: Cold Spring City	4,025
MCD: Collegeville Township	3,343
MCD: Crow Lake Township	318
MCD: Crow River Township	327
MCD: Eden Lake Township	1,542
MCD: Eden Valley City	489

**POPULATION**

**District 7 (continued)**

Stearns MN County (continued)

MCD: Elrosa City	211
MCD: Fair Haven Township	1,507
MCD: Farming Township	987
MCD: Freeport City	632
MCD: Getty Township	376
MCD: Greenwald City	222
MCD: Grove Township	493
MCD: Holding Township	1,139
MCD: Holdingford City	708
MCD: Kimball City	762
MCD: Krain Township	981
MCD: Lake George Township	335
MCD: Lake Henry City	103
MCD: Lake Henry Township	278
MCD: Luxemburg Township	637
MCD: Lynden Township	1,938
MCD: Maine Prairie Township	1,887
MCD: Meire Grove City	179
MCD: Melrose City	3,598
MCD: Melrose Township	759
MCD: Millwood Township	972
MCD: Munson Township	1,466
MCD: New Munich City	320
MCD: North Fork Township	247
MCD: Oak Township	595
MCD: Paynesville City	2,432
MCD: Paynesville Township	1,421
MCD: Raymond Township	259
MCD: Richmond City	1,422
MCD: Rockville City	2,448
MCD: Roscoe City	102
MCD: Sauk Centre City	4,317
MCD: Sauk Centre Township	1,088
MCD: Spring Hill City	89
MCD: Spring Hill Township	364
MCD: St. Anthony City	86
MCD: St. Augusta City	3,317
MCD: St. Joseph City (part)	2,830
MCD: St. Joseph Township (part)	846
MCD: St. Martin City	308
MCD: St. Martin Township	545
MCD: St. Rosa City	68
MCD: St. Stephen City	851
MCD: St. Wendel Township	2,150
MCD: Wakefield Township	2,756
MCD: Zion Township	335
<b>Stearns MN County Subtotal</b>	<b>71,088</b>
Stevens MN County	9,726

Plan:	Britton et al Congressional Plan	Administrator:	Alan Weinblatt
Type:	Congressional	User:	

**POPULATION**

**District 7 (continued)**

Swift MN County	9,783
Todd MN County	24,895
Traverse MN County	3,558
Wilkin MN County	6,576
Yellow Medicine MN County	10,438
<b>District 7 Subtotal</b>	<b>662,990</b>

**District 8**

Aitkin MN County	16,202
Beltrami MN County	
MCD: Battle Township	46
MCD: Birch Township	118
MCD: Blackduck City	785
MCD: Brook Lake Unorganized	233
MCD: Cormant Township	158
MCD: Durand Township	209
MCD: Frohn Township	1,433
MCD: Funkley City	5
MCD: Hagali Township	372
MCD: Hines Township	689
MCD: Hornet Township	232
MCD: Kelliher City	262
MCD: Kelliher Township	130
MCD: Langor Township	213
MCD: Moose Lake Township	226
MCD: Nebish Township	290
MCD: Northern Township (part)	3,613
MCD: O'Brien Township	58
MCD: Port Hope Township	673
MCD: Quiring Township	70
MCD: Shooks Township	189
MCD: Shotley Brook Unorg	25
MCD: Shotley Township	35
MCD: Sugar Bush Township	247
MCD: Summit Township	251
MCD: Taylor Township	104
MCD: Ten Lake Township	1,026
MCD: Tenstrike City	201
MCD: Turtle Lake Township	1,195
MCD: Turtle River City	77
MCD: Turtle River Township	1,085
MCD: Waskish Township	118
MCD: Woodrow Township	73
<b>Beltrami MN County Subtotal</b>	<b>14,441</b>
Carlton MN County	35,386
Cass MN County	28,567
Chisago MN County	53,887

Plan: Britton et al Congressional Plan Administrator: Alan Weimblatt  
Type: Congressional User:

**POPULATION**

**District 8 (continued)**

Cook MN County	5,176
Crow Wing MN County	62,500
Hubbard MN County	20,428
Isanti MN County	37,816
Itasca MN County	45,058
Kanabec MN County	16,239
Koochiching MN County	13,311
Lake MN County	10,866
Mille Lacs MN County	26,097
Morrison MN County	33,198
Pine MN County	29,750
St. Louis MN County	200,226
Wadena MN County	13,843
<b>District 8 Subtotal</b>	<b>662,991</b>
<b>State totals</b>	<b>5,303,925</b>





Plan: Britton et al Congressional Plan  
Plan Type: Congressional

Administrator: Alan Weinblatt  
User:

## Contiguity Report

Monday, November 14, 2011

1:24 AM

---

DISTRICT	Number of Distinct Areas
1	1
2	1
3	1
4	1
5	1
6	1
7	1
8	1

---



Plan Name: Britton et al v1  
 Plan Type: Britton et. al. US Congress  
 Date: 11/13/2011  
 Time: 2:41:31PM  
 Administrator: Alan Weinblatt

## Measures of Compactness

11/13/2011

Sum	N/A	N/A	4,428.75	N/A	N/A	N/A	N/A	N/A
Min	0.20	1.34	N/A	0.17	1.34	0.31	0.13	0.21
Max	0.52	2.27	N/A	0.53	254.06	0.93	0.68	0.53
Mean	0.37	1.72	N/A	0.33	59.90	0.70	0.35	0.40
Std. Dev.	0.11	0.33	N/A	0.13	85.69	0.25	0.20	0.11

DISTRICT	Reock	Schwartzberg	Perimeter	Polsby-Popper	Length-Width	Population Polygon	Population Circle	Ehrenburg
1	0.36	1.53	578.41	0.38	97.31	0.89	0.18	0.53
2	0.36	1.63	452.47	0.33	68.87	0.39	0.18	0.52
3	0.32	1.97	198.78	0.23	1.34	0.69	0.40	0.35
4	0.46	1.34	77.95	0.53	12.16	0.93	0.45	0.40
5	0.52	1.41	65.83	0.46	7.92	0.93	0.68	0.42
6	0.20	2.27	346.36	0.18	4.18	0.31	0.19	0.21
7	0.26	2.04	1,622.62	0.17	254.06	0.62	0.13	0.26
8	0.49	1.56	1,086.33	0.35	33.35	0.87	0.54	0.47



## Political Subdivisions Split Between Districts

---

Number of subdivisions split into more than one district:

County	7
County Subdivision	11
Voting District	10

Number of times a subdivision is split into more than one district:

County	10
County Subdivision	10
Voting District	10

Number of splits involving no population:

County	1
County Subdivision	0
Voting District	0

County	County Subdivision	Voting District	District	Population
--------	--------------------	-----------------	----------	------------

---

*Split Counties:*

Anoka MN			3	112,494
Anoka MN			6	218,350
Beltrami MN			7	30,001
Beltrami MN			8	14,441
Dakota MN			1	1,147
Dakota MN			2	248,209
Dakota MN			4	149,196
Hennepin MN			2	0
Hennepin MN			3	484,279
Hennepin MN			4	5,156
Hennepin MN			5	662,990
Le Sueur MN			1	25,519
Le Sueur MN			2	2,184
Stearns MN			6	79,554
Stearns MN			7	71,088
Wright MN			2	58,482
Wright MN			3	66,218

---

*Split MCDs:*

Anoka MN	Andover City		3	10,155
Anoka MN	Andover City		6	20,443
Anoka MN	Nowthen City		3	53
Anoka MN	Nowthen City		6	4,390
Beltrami MN	Northern Township		7	1,044
Beltrami MN	Northern Township		8	3,613
Dakota MN	Eagan City		2	1,003
Dakota MN	Eagan City		4	63,203
Hennepin MN	Edina City		3	7,863
Hennepin MN	Edina City		5	40,078
Le Sueur MN	New Prague City		1	857

---

County	County Subdivision	Voting District	District	Population
Le Sueur MN	New Prague City		2	2,184
Stearns MN	St. Joseph City		6	3,704
Stearns MN	St. Joseph City		7	2,830
Stearns MN	St. Joseph Township		6	1,078
Stearns MN	St. Joseph Township		7	846
Wright MN	Rockford Township		2	1,564
Wright MN	Rockford Township		3	1,630
Wright MN	St. Michael City		2	15
Wright MN	St. Michael City		3	16,384

*Split VTDS:*

Anoka MN	Andover City	Andover P-3	3	2,317
Anoka MN	Andover City	Andover P-3	6	187
Anoka MN	Nowthen City	Nowthen P-1	3	53
Anoka MN	Nowthen City	Nowthen P-1	6	4,390
Beltrami MN	Northern Township	Northern Twp. P-1	7	650
Beltrami MN	Northern Township	Northern Twp. P-1	8	3,613
Dakota MN	Eagan City	Eagan P-20	2	1,003
Dakota MN	Eagan City	Eagan P-20	4	2,578
Hennepin MN	Edina City	Edina P-5	3	2,184
Hennepin MN	Edina City	Edina P-5	5	661
Hennepin MN	Edina City	Edina P-6	3	544
Hennepin MN	Edina City	Edina P-6	5	1,911
Le Sueur MN	New Prague City	New Prague	1	857
Le Sueur MN	New Prague City	New Prague	2	2,184
Stearns MN	St. Joseph Township	St. Joseph Twp.	6	1,078
Stearns MN	St. Joseph Township	St. Joseph Twp.	7	846
Wright MN	Rockford Township	Rockford Twp.	2	1,564
Wright MN	Rockford Township	Rockford Twp.	3	1,630
Wright MN	St. Michael City	St. Michael P-1A	2	15
Wright MN	St. Michael City	St. Michael P-1A	3	7,267

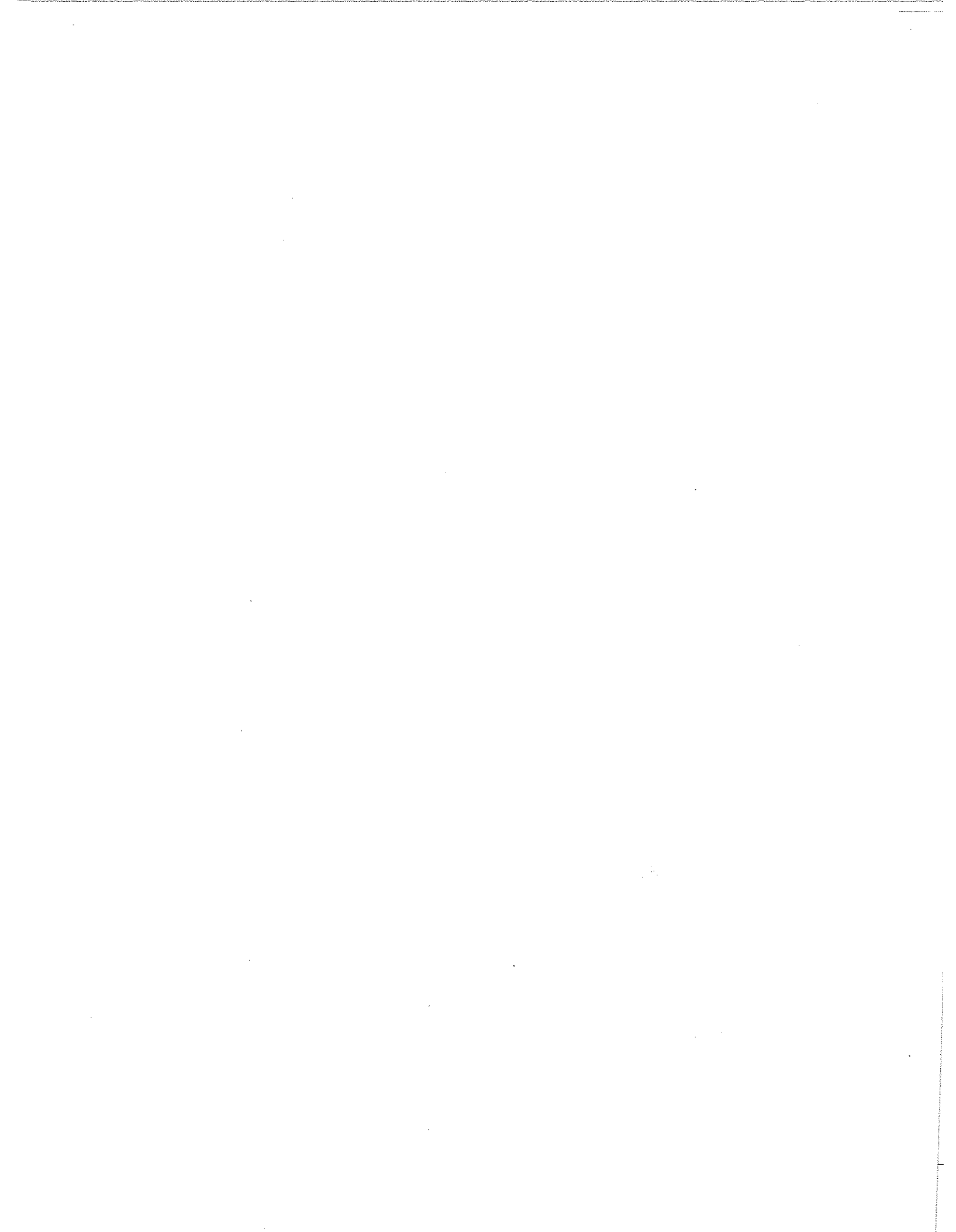

## Minority Report - Voting Age Population

### Minority Opportunity Districts (30% or more Total Minority)

District	Black	%	Asian	%	Hispanic	%	Indian	%	Other	%	Total Minority	%

District	Black	%	Asian	%	Hispanic	%	Indian	%	Other	%	Total Minority	%
1	10,162	2	11,143	2	19,242	4	2,490	0	1,203	0	44,240	8.7
2	11,265	2	15,376	3	17,643	4	2,950	1	1,542	0	48,776	10.2
3	31,167	6	28,415	6	13,925	3	3,009	1	2,094	0	78,610	16.1
4	42,292	8	43,801	9	29,992	6	4,698	1	2,947	1	123,730	24.4
5	65,040	12	29,158	6	37,441	7	7,423	1	4,206	1	143,268	27.2
6	16,504	3	18,390	4	12,113	2	4,081	1	1,523	0	52,611	10.8
7	3,395	1	5,242	1	13,479	3	13,586	3	863	0	36,565	7.2
8	4,767	1	3,477	1	5,001	1	15,301	3	872	0	29,418	5.7

#### State Totals

	184,592	5	155,002	4	148,836	4	53,538	1	15,250	0	557,218	14
--	---------	---	---------	---	---------	---	--------	---	--------	---	---------	----

#### Definitions:

- Black = 18+ Non-Hispanic Black or African American + Non-Hispanic Black or African American and White
- Asian = 18+ Non-Hispanic Asian + Non-Hispanic Asian and White
- Hispanic = 18+ Hispanic of Any Race
- Indian = 18+ Non-Hispanic American Indian and Alaska Native  
 + Non-Hispanic American Indian and Alaska Native and White
- Other = 18+ Non-Hispanic Native Hawaiian + Non-Hispanic Native Hawaiian and White  
 + Non-Hispanic Some Other Race + Non-Hispanic Some Other Race and White  
 + Non-Hispanic Other Multi-Race (where more than one minority race is listed)





STATE OF MINNESOTA  
SPECIAL REDISTRICTING PANEL  
A11-152

---

Sara Hippert, Dave Greer, Linda Markowitz,  
Dee Dee Larson, Ben Maas, Gregg Peppin,  
Randy Penrod and Charles Roulet, individually  
and on behalf of all citizens and voting  
residents of Minnesota similarly situated,

Plaintiffs,

Kenneth Martin, Lynn Wilson, Timothy O'Brien,  
Irene Peralez, Josie Johnson, Jane Krentz, Mark  
Altenburg, and Debra Hasskamp, individually and on  
behalf of all citizens of Minnesota similarly situated,

Plaintiff-Intervenors,

Audrey Britton, David Bly, Cary Coop,  
and John McIntosh, individually and on behalf  
of all citizens of Minnesota similarly situated,

Plaintiff-Intervenors,

vs.

Mark Ritchie, Secretary of State of Minnesota; and  
Robert Hiiivala, Wright County Auditor, individually and  
on behalf of all Minnesota county chief election officers,

Defendants.

---

**DESCRIPTION OF  
BRITTON INTERVENORS'  
PROPOSED  
CONGRESSIONAL  
DISTRICTS**

**Britton Congressional Plan Elements**

The Britton, *et al.* Congressional Plan is based upon the theory that Minnesota has one large, primarily agricultural district (proposed District 7), one primarily mining, forestry and recreational district (District 8), two (2) exurban districts (District 2 and

District 6), two (2) urban/suburban districts, one centered around the City of Minneapolis (District 5) and the other centered around the City of St. Paul (proposed District 4) and one western suburban/exurban district comprised of the suburban communities west of Minneapolis and along the Interstate 94/Northstar Corridor Route (District 3). It is respectfully submitted that each of these areas have their own distinctive community of interest which, while not necessarily totally the same on all issues, nevertheless are distinct from each other.

That theory, together with the requirement for absolute population equality in congressional districts, is the driving force behind this plan. It was drawn without reference to incumbency or political data. It also takes into account the demographic changes in Minnesota that have occurred over the past ten years.

### The Districts

#### Congressional District 1

Congressional District 1 needed to add population. Its 2010 population was 644,787 and therefore needed to add an additional 18,203 people in order to achieve equality. In addition, the demographics of the extreme westerly part of the district more closely match that of Congressional District 7 with its fertile agricultural land and without very large cities. In short, a rural and agricultural district.

This district is significantly the same as the district created by the Special Redistricting Panel in its Final Order dated March 19, 2002 in *Zachman, et al. v. Kiffmeyer, et al.*, Court File No. CO-01-160.

Those districts and the districts proposed by the Britton plan filed herewith, include the following whole counties: Blue Earth, Dodge, Faribault, Fillmore, Freeborn, Houston, Mower, Nicollet, Olmstead, Wabasha, Steele, Waseca, Watonwan, Winona.

This proposed plan deletes from Congressional District 1 and adds to proposed Congressional District 7 the following entire counties: Brown, Cottonwood, Jackson, Martin, Murray, Nobles, Pipestone, and Rock. All of these eight counties, in their entirety are added to Congressional District 7 with which they have a much closer agricultural community of interest.

In order to make up for the transfer of these eight counties, the Britton plan adds the entire counties of Goodhue and Rice. These counties were selected because they are immediately north of the east side of Congressional District 1 and have more in common with the remainder of Congressional District 1 than do the eight deleted counties.

The only counties split in the creation of Congressional District 1 are:

1. Le Sueur County. This county had also been split by the Zachman Panel. The only part of Le Sueur County that is not in Congressional District 1 is a part of the City of New Prague which is more exurban than rural. Therefore it is in District 2.
2. Dakota. Northfield City in its entirety has been added to District 1 in order to balance the district population and to keep the city whole.

Congressional District 1 under the Britton plan remains a southern Minnesota district but with a recognition that it has more in common geographically, economically and socially, with its northern neighbors of Goodhue, Rice and Le Sueur than with its extreme westerly components. It remains focused on Interstate 90 and also remains an east-west district.

### Congressional District 2

Congressional District 2 was too large with the 2010 population of 732,515. It therefore needed to transfer out 69,524 people.

As in the Plan adopted by the Special Redistricting Panel in *Zachman v. Kiffmeyer*, *supra*, Final Order dated March 19, 2002, the Britton plan includes the whole counties

of Scott and Carver, which were two of the fastest growing counties in the state during the last decade and which comprise the core of Congressional District 2.

The Britton plan transfers to Congressional District 1 the whole counties of Rice and Goodhue because they and Le Sueur County are all outside of the eleven county metropolitan area and are really not yet exurban. Furthermore, their ties are more directly to the south with Congressional District 1. The only exception is the City of Northfield.

The proposed plan adds to Congressional District 2, in order to make up for the loss of Rice and Goodhue, the counties of Meeker, McLeod, Renville, Sibley and Kandiyohi because they are more closely tied to the Scott County – Carver County core of Congressional District 2 than they are to the agricultural districts along the western border of the state which is proposed as Congressional District 7.

The only split counties in proposed Congressional District 2 are:

1. Le Sueur, which contributes only a portion of the City of New Prague to Congressional District 2, with the rest remaining with Congressional District 1. The portion of New Prague that is transferred to Congressional District 2 is that which abuts Scott County.
2. Wright County, which is divided between proposed Congressional District 2 and proposed Congressional District 3 by deleting Clearwater City,

Clearwater Township, Silver Creek Township, Monticello City, Monticello Township and Otsego from Congressional District 2 and placing them in proposed Congressional District 3. Congressional District 2 was simply too big.

3. Rockford and St. Michael are split between Congressional Districts 2 and 3 simply because 15 more people were needed to achieve population equality and one census block was found in St. Michael with precisely that population.
4. Dakota, which contributes the most exurban and rural southern portions of that county which are more closely aligned with eastern Scott County than they are with the southern suburbs of St. Paul that are in proposed as Congressional District 4. This proposal divides Dakota County between Congressional Districts 2 and 4 but keeps Washington County intact.

Proposed Congressional District 2 is an exurban district with the exception of Meeker, Renville and Kandiyohi counties, but it is respectfully submitted that those counties are more closely aligned with the southwestern exurban part of the Twin Cities than they are with the wonderful agricultural district ranging from the Canadian border to the Iowa border.

### Congressional District 3

Congressional District 3 surprisingly needed to gain population from its census figure of 650,185. That is an indication that this district did not gain population as fast as its southerly neighbor (Congressional District 2) or its easterly neighbor (Congressional District 6).

Proposed Congressional District 3 therefore is a suburban district comprised of (a) Anoka County suburbs in the northeast, (b) Hennepin County suburbs in the middle, and (c) Wright County suburbs in the northwest. It is entirely within the eleven county metropolitan area and includes only the most suburban (not exurban or rural) parts of those three counties.

To the old Congressional District 3, the Britton plan adds the following:

1. Anoka City in its entirety.
2. All of Coon Rapids, which was previously split.
3. All of Ramsey City.
4. One-third of Andover City.
5. All of the northern and western suburbs of Hennepin County.
6. One census block of Nowthen City to achieve population equality.



The Britton plan retains as part of Congressional District 3 the following whole cities:

1. Brooklyn Center
2. Brooklyn Park
3. Champlain
4. Corcoran
5. Dayton
6. Deephaven
7. Eden Prairie
8. Excelsior
9. Greenfield
10. Greenwood City
11. Hassan
12. Hopkins – which is now made whole and no longer split
13. Independence
14. Long Lake
15. Loretto
16. Maple Grove City
17. Maple Plain City
18. Medicine Lake
19. Medina
20. Minnetonka City
21. Minnetonka Beach

22. Minnetrista
23. Mound
24. Orono
25. Osseo
26. Plymouth
27. Rogers
28. Shorewood
29. Spring Park City
30. St. Bonifacius City
31. Tonka Bay City
32. Wayzata City
33. Woodland City

Edina has been divided between proposed Congressional Districts 3 and 5 instead of dividing Hopkins as in the *Zachman* Panel's 2002 decision, because Hopkins is smaller and therefore more homogeneous than Edina. It also seems more rational to keep the smaller city intact. Second, Hopkins is more closely paired with Minnetonka than with St. Louis Park. The Hopkins Minnetonka pairing also more closely follows the school district lines.

Proposed Congressional District 3 also adds the following portions of Wright County in their entirety:

1. Albertville
2. Clearwater City
3. Clearwater Township
4. Hanover City
5. Monticello City
6. Monticello Township
7. Otsego
8. Rockford City
9. Silver Creek Township

It also includes parts of St. Michael City and Rockford Township.

#### Congressional District 4

This Congressional District shows a deviation from the ideal population of 48,367 people and needs to grow significantly.

The Britton plan proposes to keep Ramsey County wholly intact and to add to its population (508,640 people) the City of St. Anthony and such of the northerly suburbs of Dakota County that are necessary to achieve population equality as follows:

1. All of Inver Grove Heights – which would no longer be split.
2. Lilydale (already in CD4)
3. Mendota City (already in CD4)

4. Mendota Heights (already in CD4)
5. South St. Paul (already in CD4)
6. West St. Paul (already in CD4)
7. Sunfish Lake (to be added)

The plan would also add most of Eagan which is closely tied to the above St. Paul suburbs, i.e., all of Eagan east of Highway 3 and south of 110<sup>th</sup> Street. The east boundary is the Eagan City line. This portion of Eagan is deleted only to balance the population of Congressional District 4.

The proposed plan deletes all of Washington County from Congressional District 4 so that county would no longer be split.

Thus, the proposal is for a Ramsey County, Dakota County district with St. Anthony, which is most closely associated with Ramsey County, added.

The district does not include any portion of the City of Minneapolis. There is simply no logical or legal reason to do so.

## Congressional District 5

This is the Congressional District that includes all of the City of Minneapolis (382,578 people) and the following suburbs of that city:

1. Bloomington
2. Richfield (already in CD5)
3. St. Louis Park (already in CD5)
4. Golden Valley (already in CD5)
5. Fort Snelling Unorganized (already in CD5)
6. New Hope (already in CD5)
7. Crystal (already in CD5)
8. Robbinsdale (already in CD5)

It also includes the adjacent parts of Edina that are needed to achieve population equality.

The plan deletes all parts of Anoka County and all parts of Ramsey County that are currently in Congressional District 5 and also deletes all parts of Hopkins (transferred to proposed CD3) which will therefore no longer be split.

This is truly a Minneapolis and suburban district.

## Congressional District 6

This is the congressional district that has grown the fastest with the 2010 census population of 759,478 requiring that it lose 96,487 people in order to achieve population equality.

In order to accomplish that requirement, the Britton plan proposes that:

1. Congressional District 6 drop all of its population of Ramsey County (i.e., Blaine) into Congressional District 4.
2. Congressional District 6 lose all of its population of Hennepin County (Hanover and Rockford) into Congressional District 3.
3. Congressional District 6 lose all of its Wright County population because that county's population has more in common with its neighbors in Congressional District 2 on its southern boundary and with Congressional District 3 on its eastern boundary than it has with Washington and Anoka Counties which form the core of proposed Congressional District 6. The statements made by the Assistant Wright County Attorney at the hearing on open issues confirms this proposal.
4. This Congressional District retain all of its population in Benton and Sherburne counties.
5. Congressional District 6 acquire all of the population of Washington County, thus no longer splitting that county (238,136 people).

6. That it acquire most all of Anoka County.

Thus, the district would become a Washington, Benton, Sherburne, most of Anoka (northerly part) and part of Stearns. This would reduce it from eight counties down to five.

St. Joseph City and St. Joseph Township have both been split. This is proposed to avoiding splitting Waite Park and the St. Cloud metropolitan area. The particular lines chosen for the split reflect municipal boundaries and attempt to account for the fact that if Interstate 94 were used as the boundary, population equality would not be achieved.

The Britton Plaintiffs are fully aware of the public testimony of some Washington County residents that they would prefer to be added to a congressional district with Ramsey County than to remain with Benton, Sherburne, Stearns and Wright counties. The problem with that approach is that Washington County, when added to Ramsey County, is too big (746,776 people). Thus either Washington County or Ramsey County would have to be needlessly split. Under the Britton proposal, neither Ramsey nor Washington County would be split. A second negative consequence of adopting the concept of adding Washington County to Ramsey County would be that Congressional District 4 would have to sever its historic ties to Dakota County (i.e., West St. Paul, South St. Paul, Mendota Heights and Inver Grove Heights) which would gain nothing. It is submitted that those suburbs have more in common with St.

Paul than does Washington County. However, the concerns of those Washington County citizens who spoke have been heard. As a consequence, the Britton Plaintiffs propose to detach Wright County from Congressional District 6.

Congressional District 7

This primarily agricultural district requires a population gain of 37,479 people in order to achieve population equality. It is this district which suggests more changes from the current configuration than any of the other districts.

The first proposed change is that the following counties, in their entirety, be added to current Congressional District 7:

Rock	9,687
Nobles	21,378
Jackson	10,266
Martin	20,840
Brown	25,893
Cottonwood	16,687
Pipestone	9,596
Murray	8,725



The reason for this proposal is because those eight counties in the extreme southwestern corner of the state have more in common as quality agricultural land with the counties north of them than they do with the counties east of them. This is and should remain an agricultural congressional district. Furthermore, those eight counties should not be split off from those counties north of them with a similar agricultural interest even though it extends to the Canadian border. On the other hand, the counties east of these eight have larger urban oriented areas and cities (e.g. Albert Lea, Austin, Rochester, Owatonna, etc.).

Second, as a consequence of the addition of those eight counties, Congressional District 7 would have to lose population on its eastern border. The Britton proposal is that the counties of Renville, Kandiyohi, Meeker, McLeod and Sibley be added to Congressional District 2. Sibley, McLeod and Meeker all abut the eleven county metropolitan area and certainly have more in common with Scott, Carver and Wright than they do with the northwestern corner of the State of Minnesota. Similarly, Kandiyohi County and Renville County, which border Sibley, McLeod and Meeker, are tied to those counties by Highways 12 and 212. Those east-west transportation corridors tie together this entire central part of the state. Kandiyohi and Renville certainly are not tied to those counties that form the western border of Minnesota.

Beltrami County remains split under the Britton proposal but a greater portion of its population is moved into Congressional District 8. In addition, a good faith attempt

has been made to keep as many Native American areas in the same congressional district as possible. Thus Beltrami is divided along the eastern border of the Red Lake Reservation. All of the main parts of Red Lake and White Earth are in District 7. The City of Bemidji remains undivided. Northern Township (Precinct 2 and most of Precinct 1) is split in order to achieve population equality.

Finally, Stearns County is divided between Congressional District 7 and Congressional District 6 in a manner similar to the division ordered by the Special Redistricting Panel in *Zachman v. Kiffmeyer, supra*, Court File No. CO-01-160, but modified to achieve population equality. The main divisions are within the City of St. Joseph, St. Joseph Township and Nowthen Township. Congressional District 7 includes all of precinct 2 of Nowthen and a part of precinct 1. Most of St. Joseph Township and one precinct of the City of St. Joseph are in Congressional District 7 to achieve population equality. They were selected in order to keep all of the St. Cloud metropolitan area in a single congressional district.

#### Congressional District 8

This district needs to pick up only 2,649 more people in order to achieve population equality. Therefore, the Britton plan continues to keep the counties of Aitkin, Carlton, Cass, Chisago, Cook, Crow Wing, Hubbard, Isanti, Itasca, Kanabec, Koochiching,

Lake, Mille Lacs, Morrison, Pine, St. Louis and Wadena all whole and all in the same congressional district.

The only significant change is to expand Congressional District 8 further into Beltrami County to add the additional population necessary for equality and to make a good faith effort to keep Native American reservations intact and not split.

Simply put, this district is an Iron Range, Duluth, Arrowhead and Mille Lacs area district. There is no need or reason to change it.

## CONCLUSION

The proposed Congressional districts were all created “incumbent blind,” without reference to residences. They were also created without attention to voting patterns but are believed to reflect the political makeup of each district. They do not violate any portion of the Voting Rights Act. Finally, each district reflects the varying interests of their inhabitants. The Britton Plaintiffs respectfully submit this Plan in the belief that it creates districts that are an accurate reflection of the current and changing interests of each part of the state. The Britton Plaintiffs are very proud of this Plan and submit it for the Panel’s consideration.

Respectfully Submitted,

Dated: November 18, 2011

s/Alan W. Weinblatt  
Alan W. Weinblatt (#115332)  
Jay Benanav (#0006518)  
Jane L. Prince (#0388669)  
WEINBLATT & GAYLORD, PLC  
111 East Kellogg Boulevard, Suite 300  
St. Paul, MN 55101  
Telephone: (651) 292-8770  
Facsimile: (651) 223-8282  
alan@weglaw.com

*Attorneys for Plaintiff- Intervenors Britton, et al.*



# Britton et al Congressional Plan

## State Map

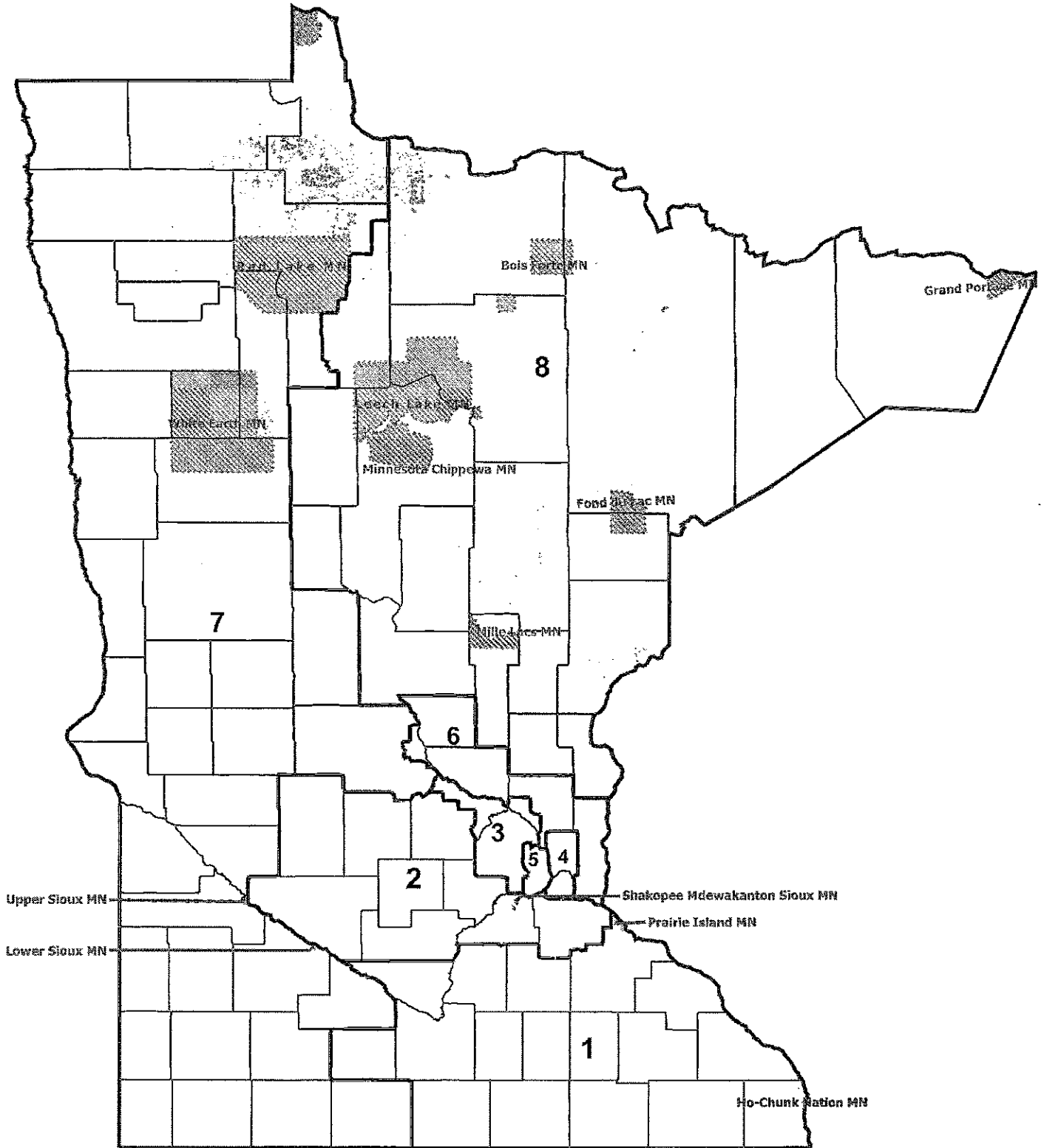







# Britton et al Congressional Plan District 1

County	Population
Blue Earth MN County	64,013
Dakota MN County (Part)	1,147
Dodge MN County	20,087
Faribault MN County	14,553
Fillmore MN County	20,866
Freeborn MN County	31,255
Goodhue MN County	46,183
Houston MN County	19,027
Le Sueur MN County (Part)	25,519
Mower MN County	39,163
Nicollet MN County	32,727
Olmsted MN County	144,248
Rice MN County	64,142
Steele MN County	36,576
Wabasha MN County	21,676
Waseca MN County	19,136
Watonwan MN County	11,211
Winona MN County	51,461
<b>District 1 Subtotal</b>	<b>662,990</b>

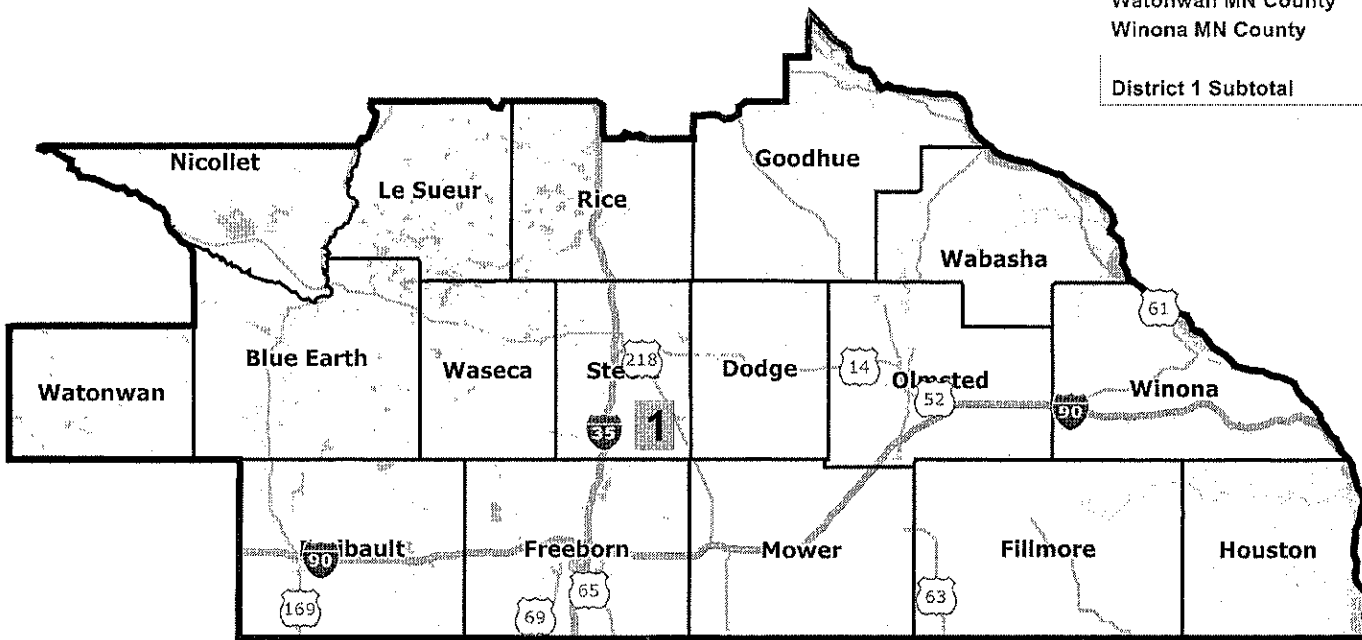

**Legend**

- Water Area
- County
- Congressional District
- Interstate
- US Highway

# Britton et al Congressional Plan District 2

Britton et al# US Congress Plan: Britt		F6
County	Population	
Carver MN County	91,042	
Dakota MN County (Part)	248,209	
Hennepin MN County (Part)	0	
Kandiyohi MN County	42,239	
Le Sueur MN County (Part)	2,184	
McLeod MN County	36,651	
Meeker MN County	23,300	
Renville MN County	15,730	
Scott MN County	129,928	
Sibley MN County	15,226	
Wright MN County (Part)	58,482	
<b>District 2 Subtotal</b>	<b>662,991</b>	

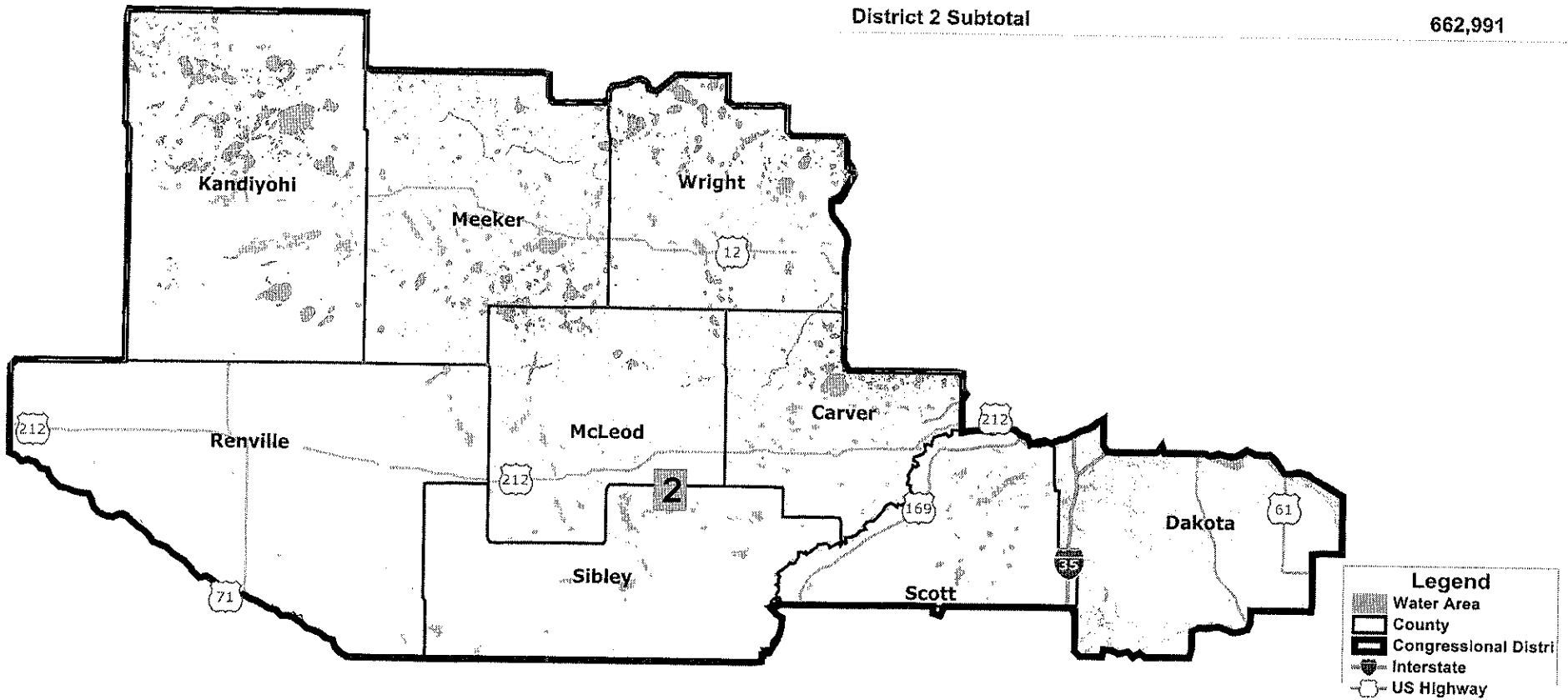

# Britton et al Congressional Plan - District 3

Britton et al#	US Congress Plan: Britt	F2	F6
County			Population
Anoka MN County (Part)		Andover City (Part) Nowthen City (Part)	112,494 10,155 53
Hennepin MN County (Part)		Edina City (Part)	484,279 7,863
Wright MN County (Part)		Rockford Township (Part) St. Michael City (Part)	66,218 1,630 16,384
District 3 Subtotal			662,991

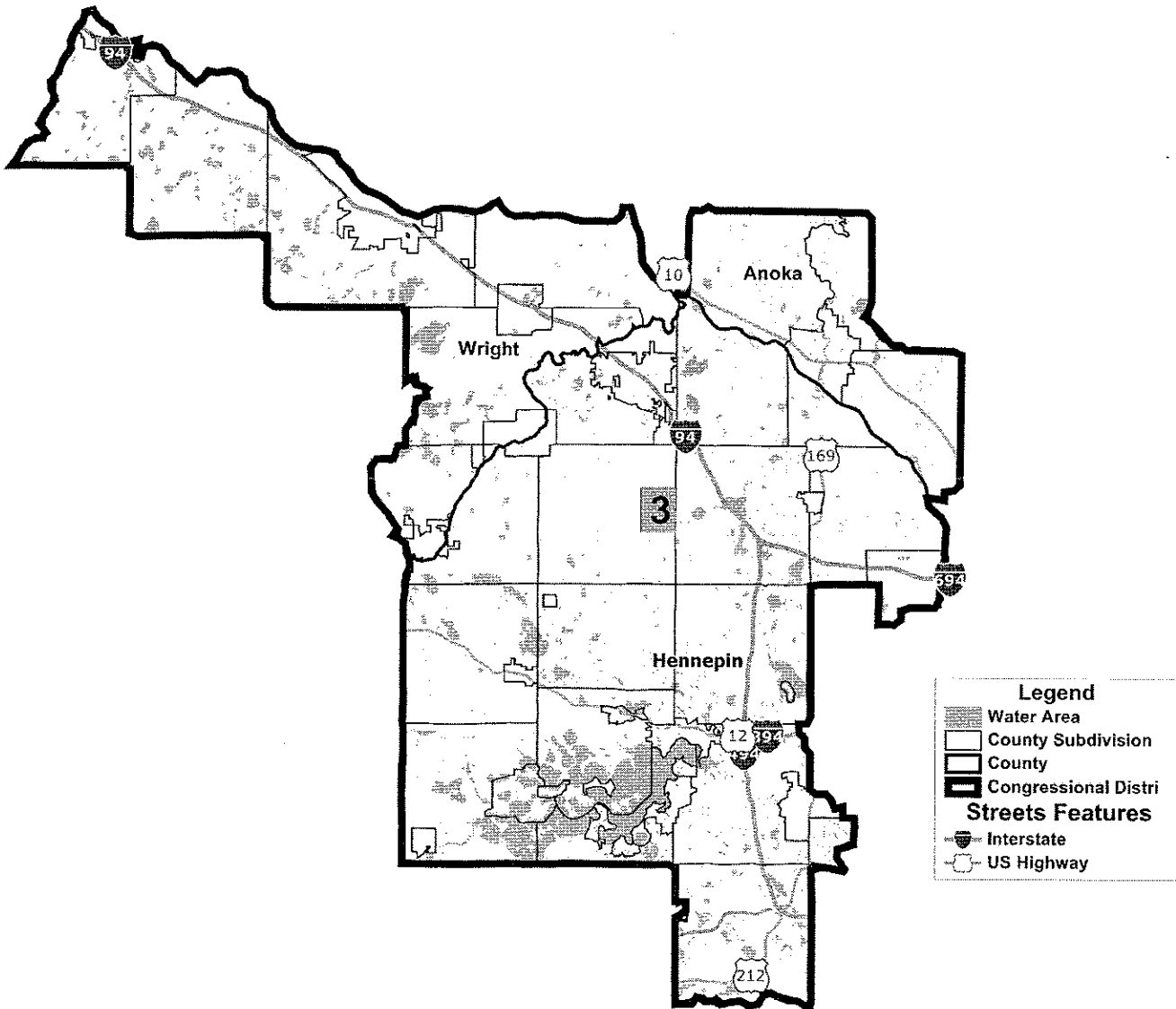

# Britton et al Congressional Plan District 4

Britton et al# US Congress Plan: Britt

F2

F6

County	Population
Dakota MN County (Part)	149,196
Eagan City (Part)	63,203
Hennepin MN County (Part)	5,156
Ramsey MN County	508,640
<b>District 4 Subtotal</b>	<b>662,992</b>

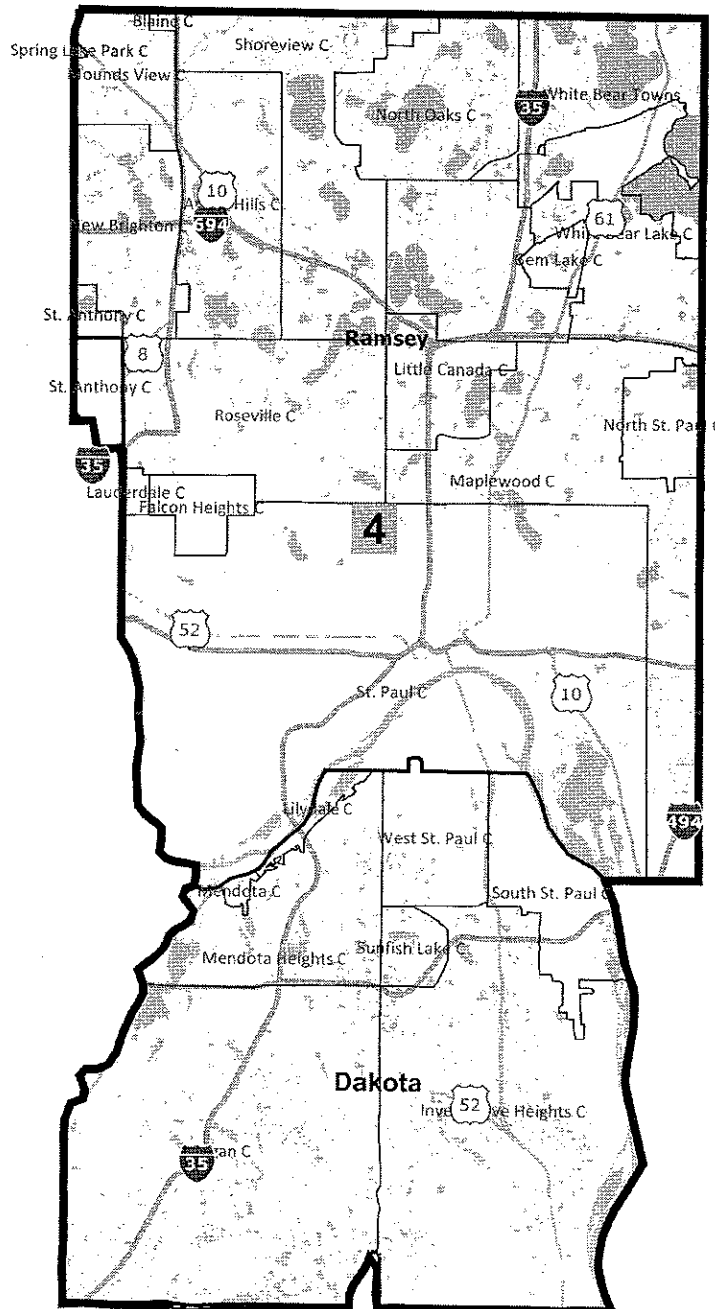

**Legend**

- Water Area
- County Subdivision
- County
- Congressional District
- Interstate
- US Highway

# Britton et al Congressional Plan District 5

Britton et al# US Congress Plan: Britt

F2

F6

Hennepin MN County (Part)

662,990

Edina City (Part)

40,078

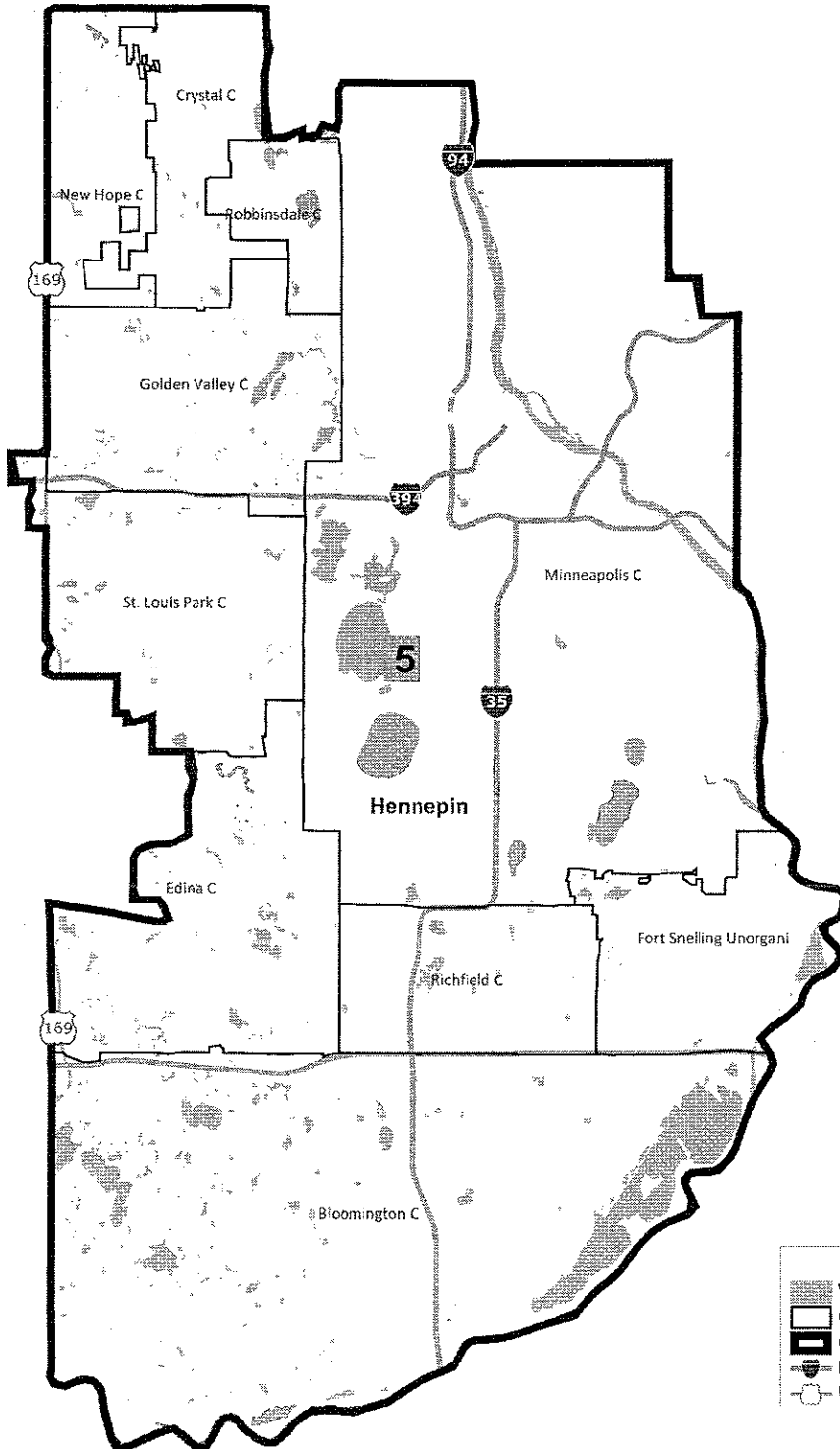

# Britton et al Congressional Plan District 6

Britton et al# US Congress Plan: Brltt		F2	F6
			<b>Population</b>
Anoka MN County (Part)		Andover City (Part)	218,350
		Nowthen City (Part)	20,443
Benton MN County			4,390
Sherburne MN County			38,451
Stearns MN County (Part)			88,499
		St. Joseph City (Part)	79,554
		St. Joseph Township (Part)	3,704
Washington MN County			1,078
District 6 Subtotal			238,136
			<b>662,990</b>

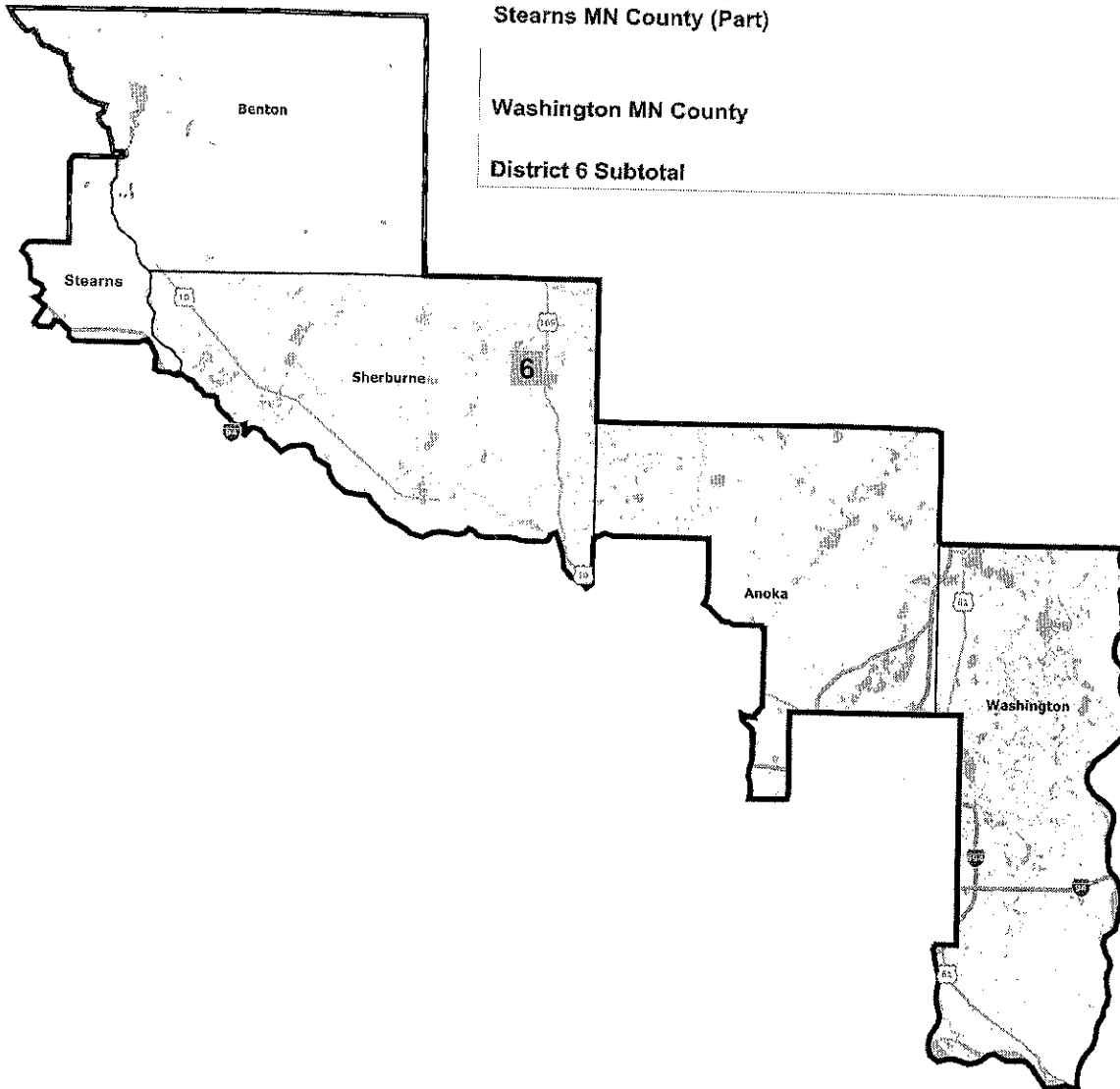

**Legend**

- Water Area
- County
- Congressional District
- Interstate
- US Highway

# Britton et al Congressional Plan District 7

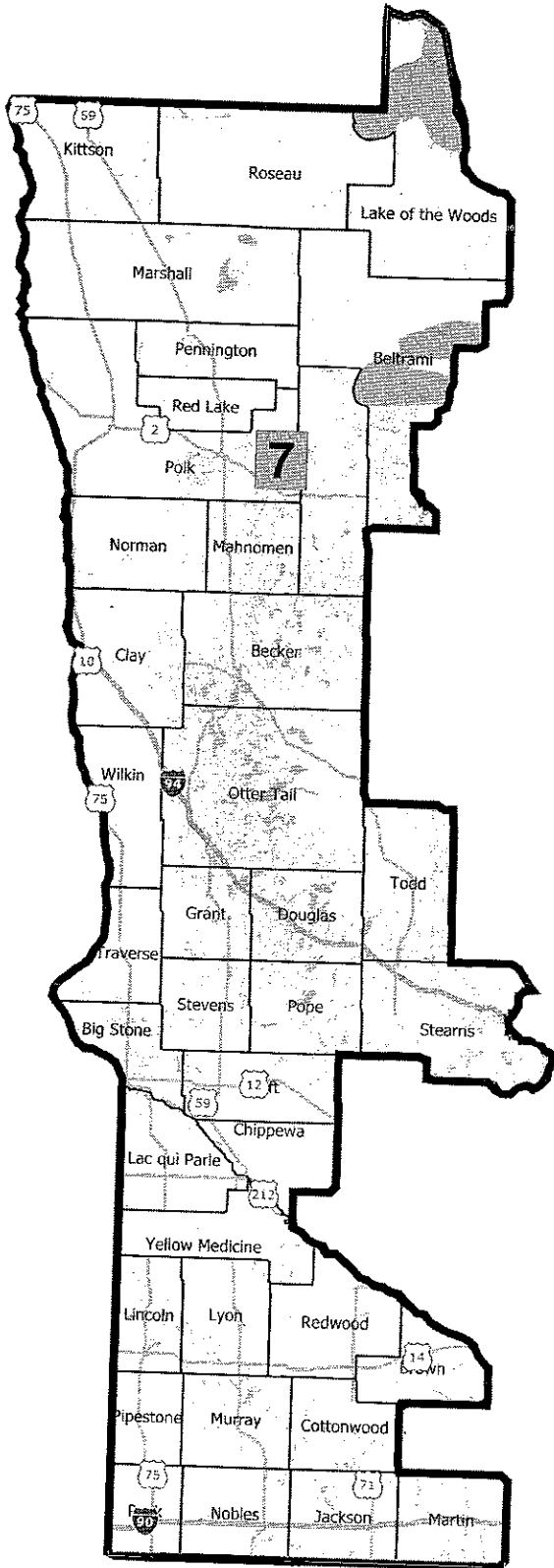

Britton et al US Congress Plan: Britt		F6
County		Population
Becker MN County		32,504
Beltrami MN County (Part)		30,001
Big Stone MN County		5,269
Brown MN County		25,893
Chippewa MN County		12,441
Clay MN County		58,999
Clearwater MN County		8,695
Cottonwood MN County		11,687
Douglas MN County		36,009
Grant MN County		6,018
Jackson MN County		10,266
Kittson MN County		4,552
Lac qui Parle MN County		7,259
Lake of the Woods MN County		4,045
Lincoln MN County		5,896
Lyon MN County		25,857
Mahnomen MN County		5,413
Marshall MN County		9,439
Martin MN County		20,840
Murray MN County		8,725
Nobles MN County		21,378
Norman MN County		6,852
Otter Tail MN County		57,303
Pennington MN County		13,930
Pipestone MN County		9,596
Polk MN County		31,600
Pope MN County		10,995
Red Lake MN County		4,089
Redwood MN County		16,059
Rock MN County		9,687
Roseau MN County		15,629
Stearns MN County (Part)		71,088
Stevens MN County		9,726
Swift MN County		9,783
Todd MN County		24,895
Traverse MN County		3,558
Wilkin MN County		6,576
Yellow Medicine MN County		10,438
<b>District 7 Subtotal</b>		<b>662,990</b>

**Legend**

- Water Area
- County
- Congressional District
- Interstate
- US Highway

# Britton et al Congressional Plan - District 8

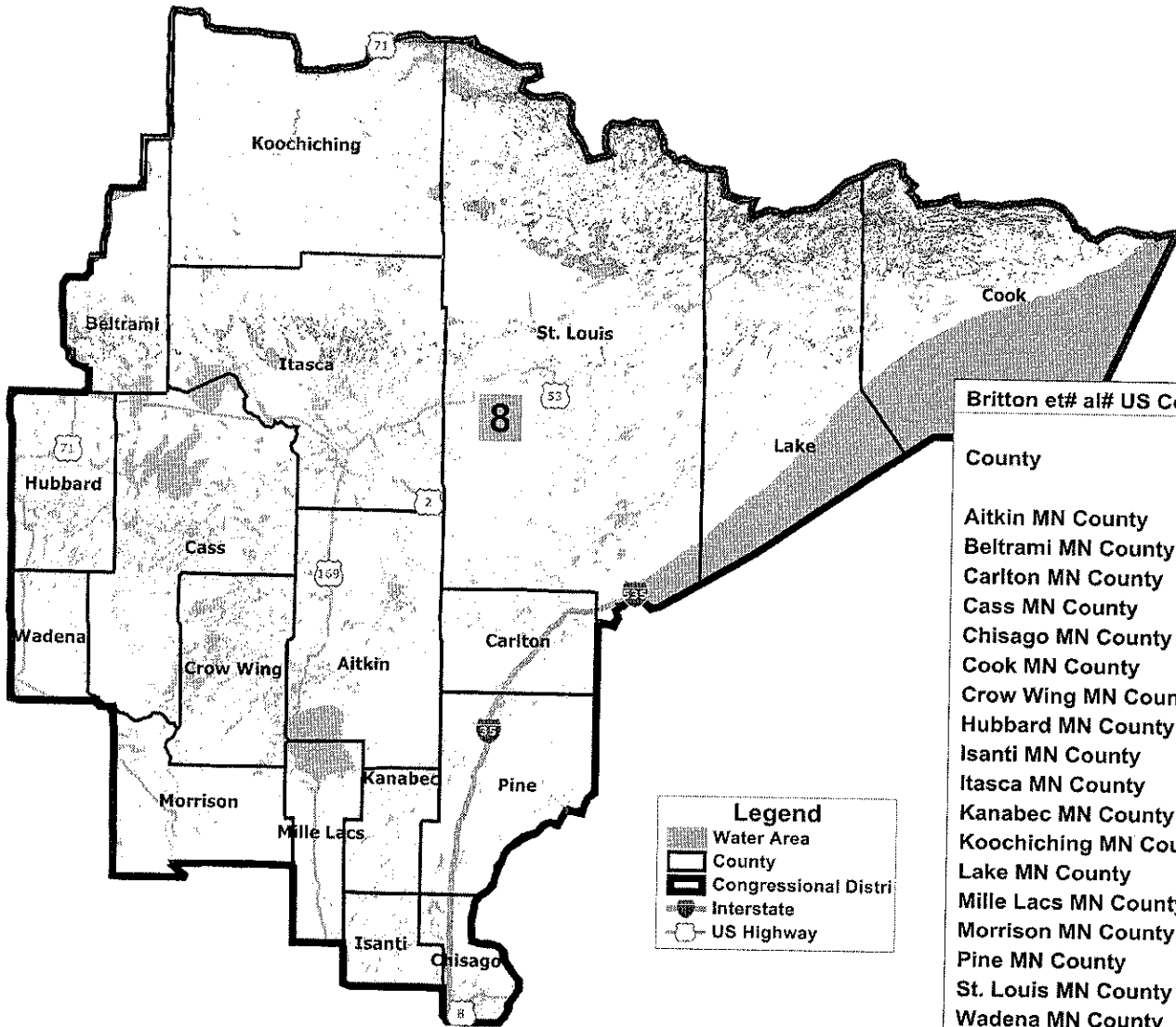

Britton et al# US Congress Plan: Britt		F6
County	Population	
Aitkin MN County	16,202	
Beltrami MN County (Part)	14,441	
Carlton MN County	35,386	
Cass MN County	28,567	
Chisago MN County	53,887	
Cook MN County	5,176	
Crow Wing MN County	62,500	
Hubbard MN County	20,428	
Isanti MN County	37,816	
Itasca MN County	45,058	
Kanabec MN County	16,239	
Koochiching MN County	13,311	
Lake MN County	10,866	
Mille Lacs MN County	26,097	
Morrison MN County	33,198	
Pine MN County	29,750	
St. Louis MN County	200,226	
Wadena MN County	13,843	
<b>District 8 Subtotal</b>	<b>662,991</b>	



# Britton et al Congressional Plan County Split - Anoka

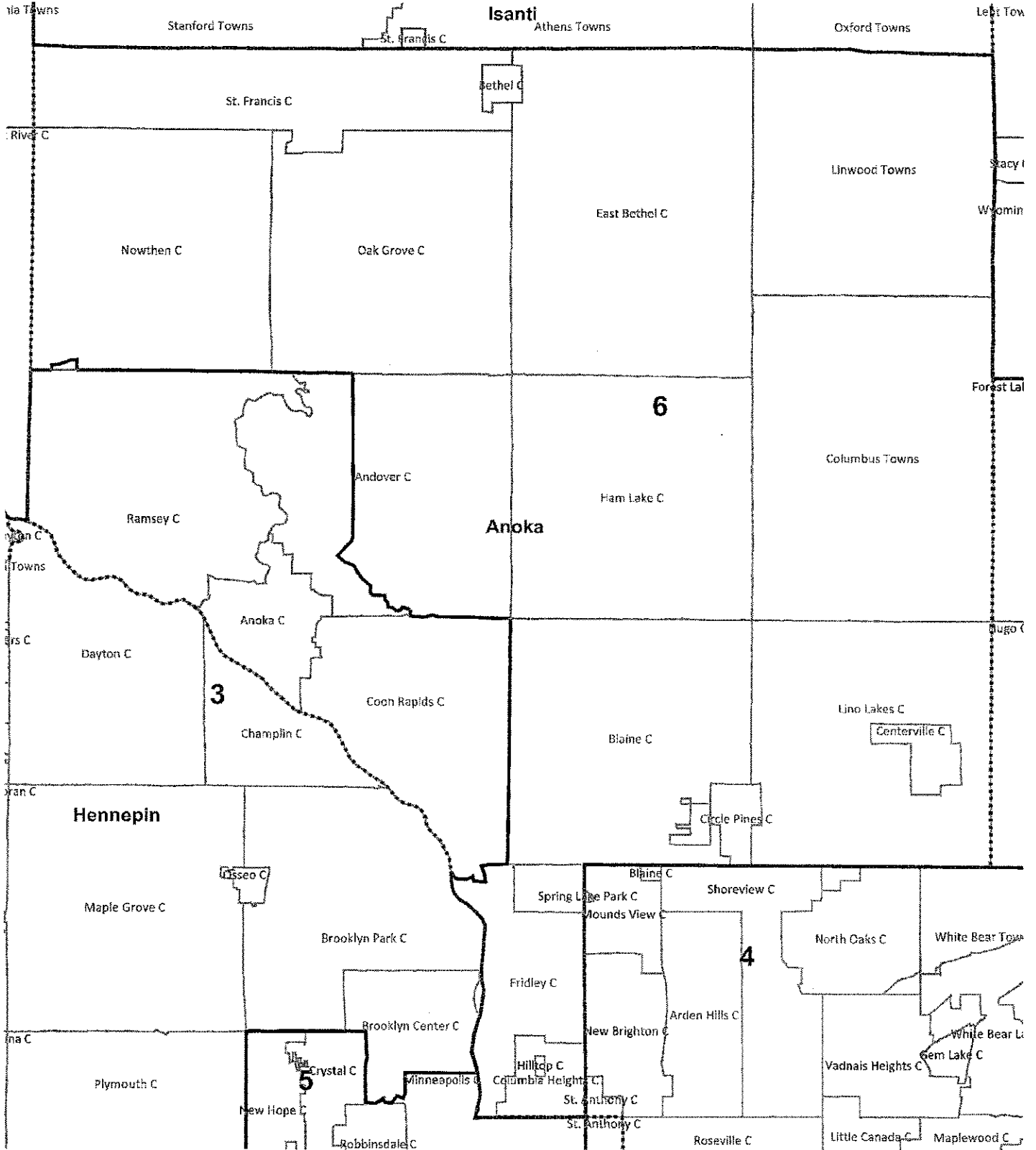

# Britton et al Congressional Plan County Split - Beltrami

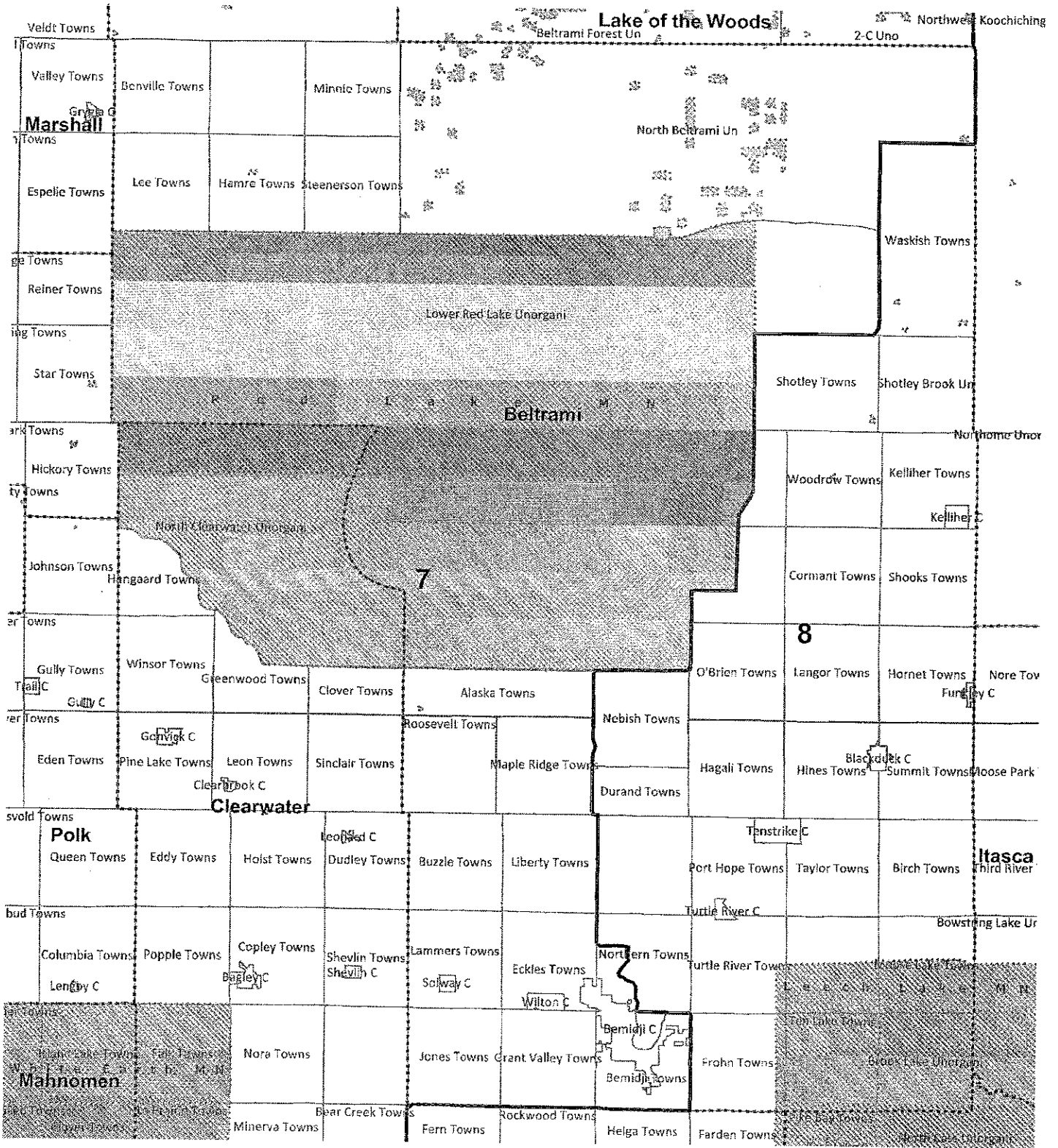



# Britton et al Congressional Plan County Split - Hennepin

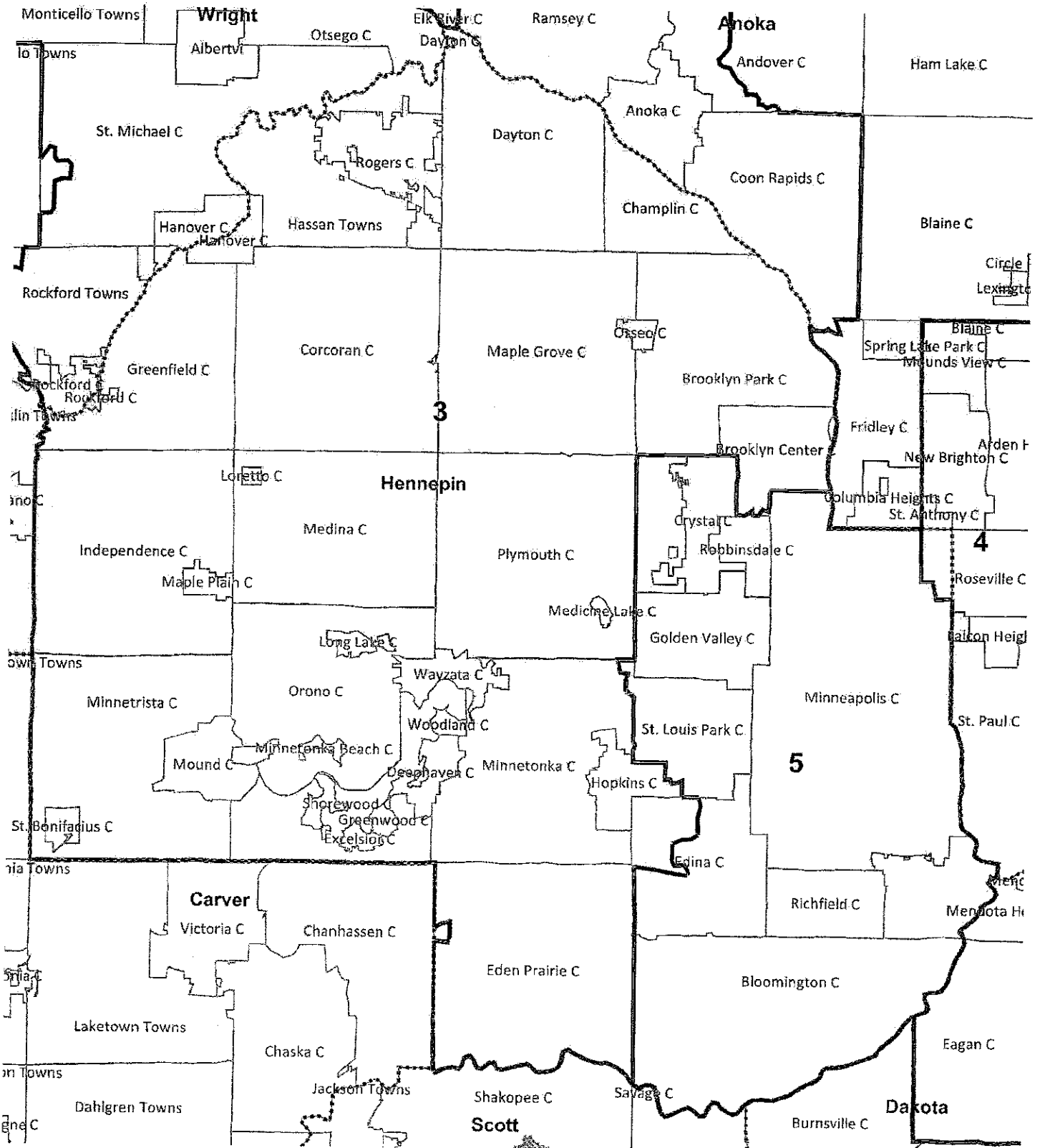



# Britton et al Congressional Plan County Split - Stearns

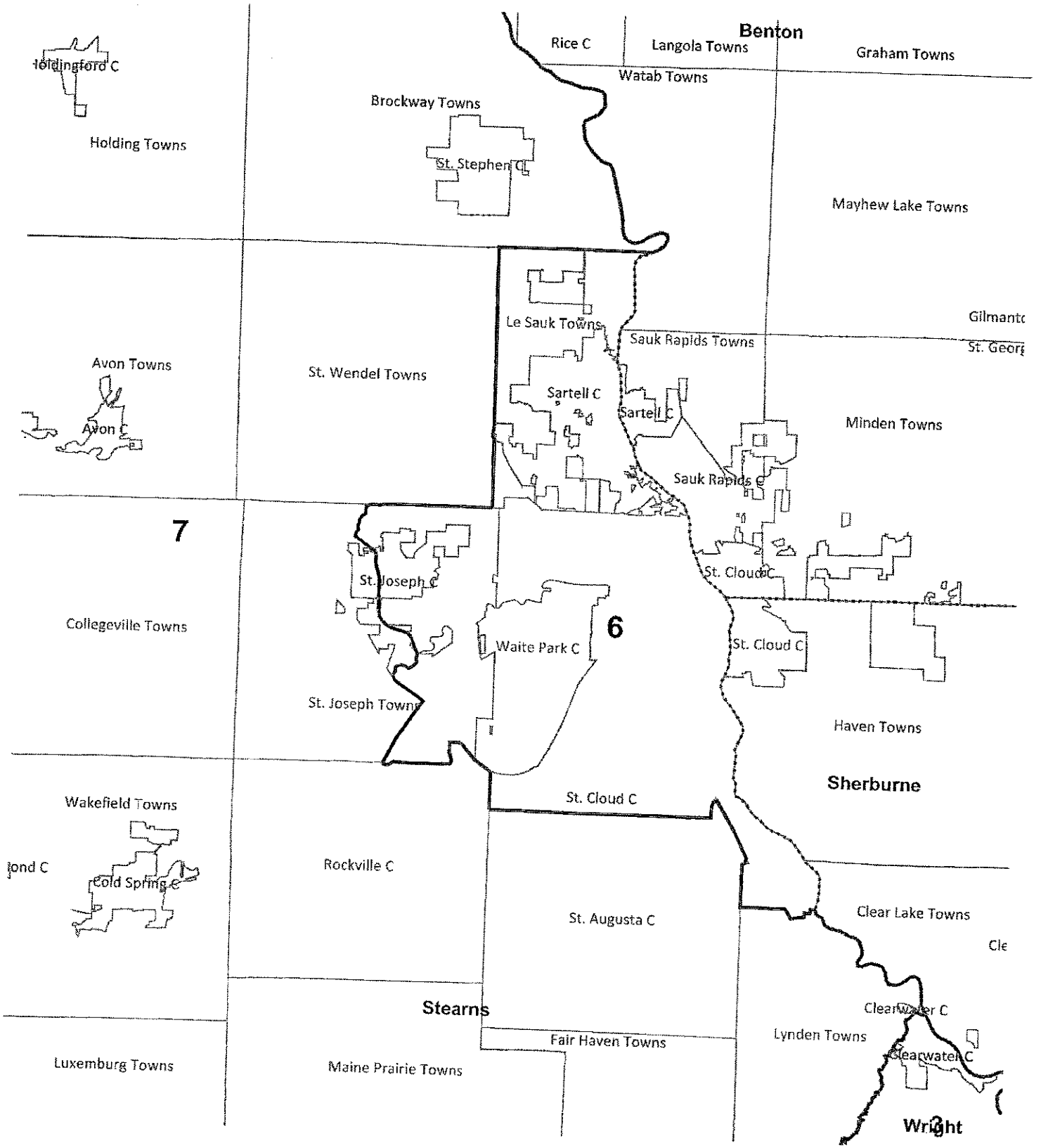

Holdingford C

Holding Towns

Avon Towns  
Avon C

7

Collegeville Towns

Wakefield Towns  
Cold Spring C

Luxemburg Towns

Brockway Towns

St. Stephen C

St. Wendel Towns

Le Sauk Towns

Sartell C

Sauk Rapids Towns

Sartell C

Sauk Rapids C

St. Joseph C

St. Cloud C

Waite Park C

6

St. Cloud C

St. Joseph Towns

Haven Towns

Sherburne

Rockville C

St. Cloud C

St. Augusta C

Clear Lake Towns

Stearns

Fair Haven Towns

Lynden Towns

Clearwater C

Clearwater C

Wright

Benton

Rice C

Langola Towns

Graham Towns

Watab Towns

Mayhew Lake Towns

Gilmantown

St. George

Minden Towns

Cle



# Britton et al Congressional Plan City Split - Andover (Anoka)

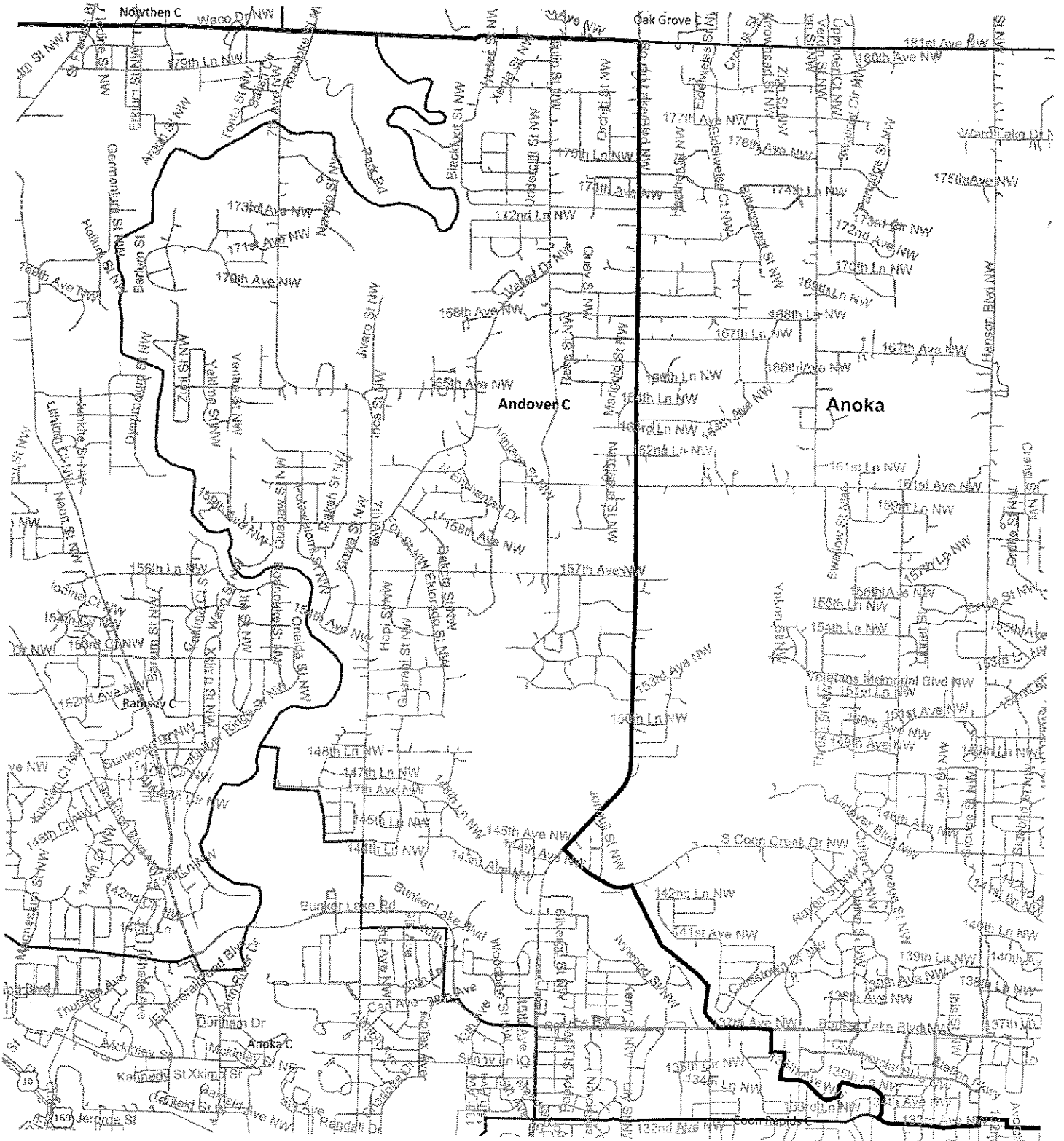



# Britton et al Congressional Plan City Split - Eagan (Dakota)

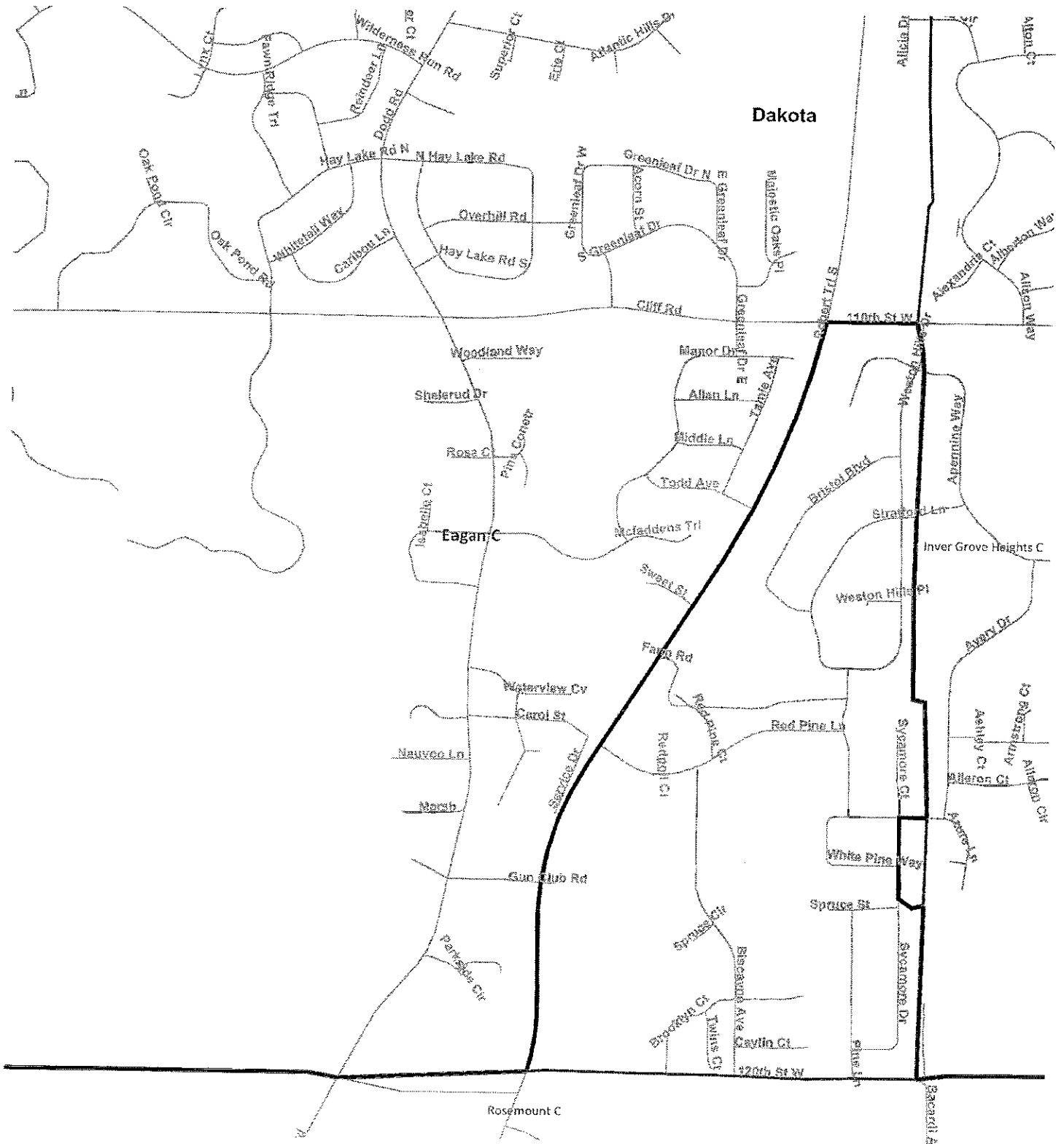

# Britton et al Congressional Plan City Split - Edina (Hennepin)

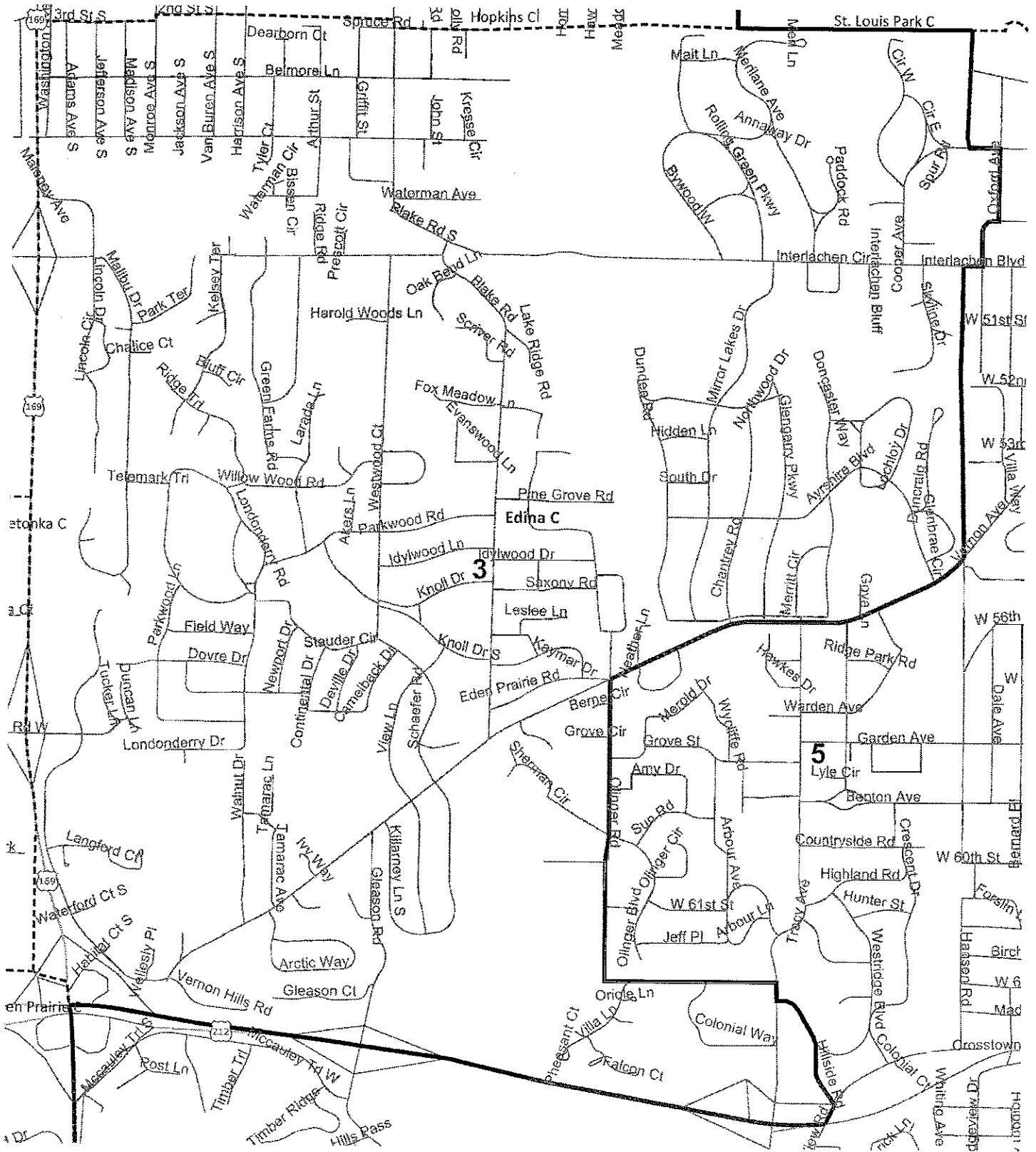



# Britton et al Congressional Plan City Split - Nowthen (Anoka)

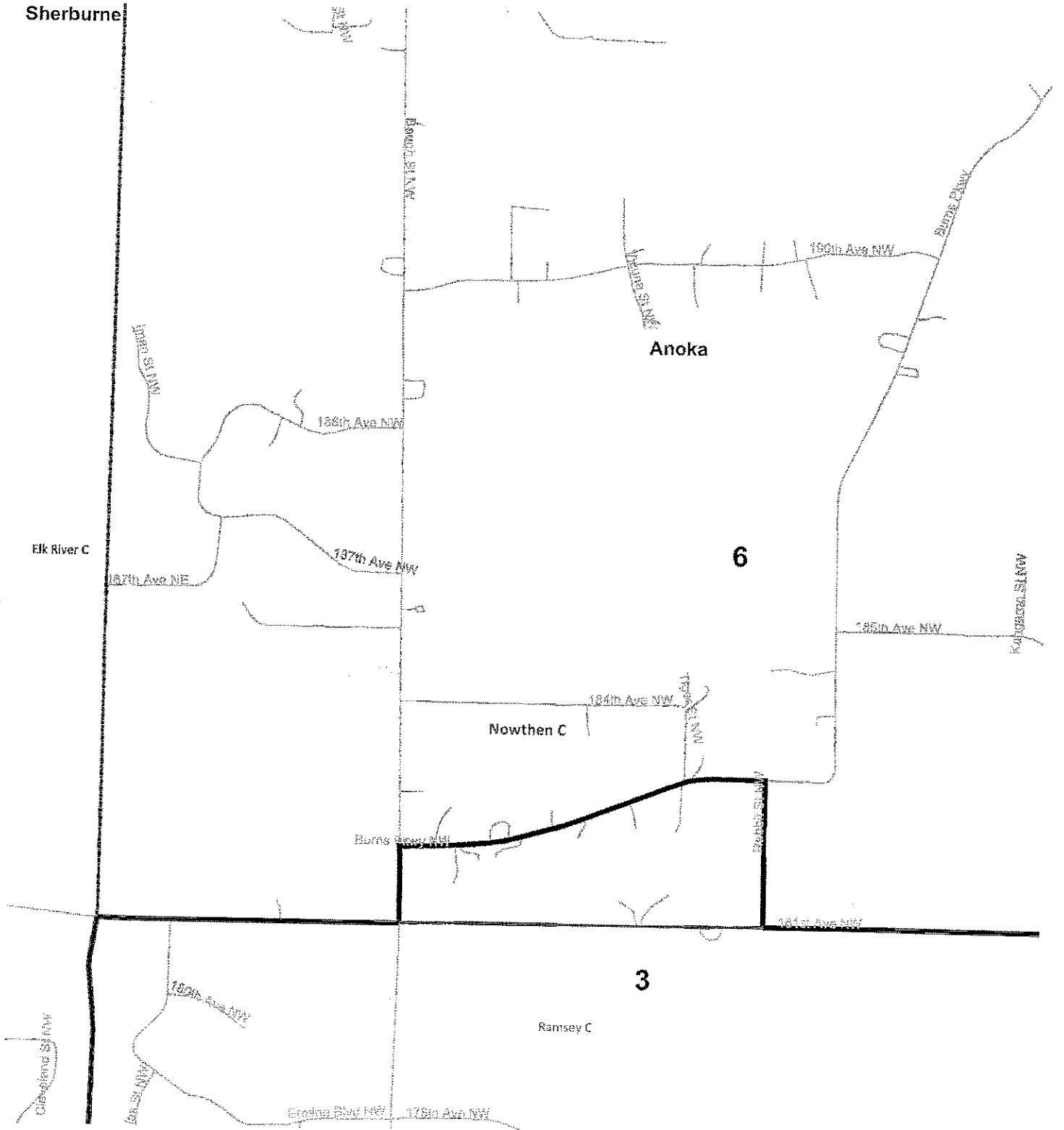



# Britton et al Congressional Plan City Split - St. Michael (Wright)

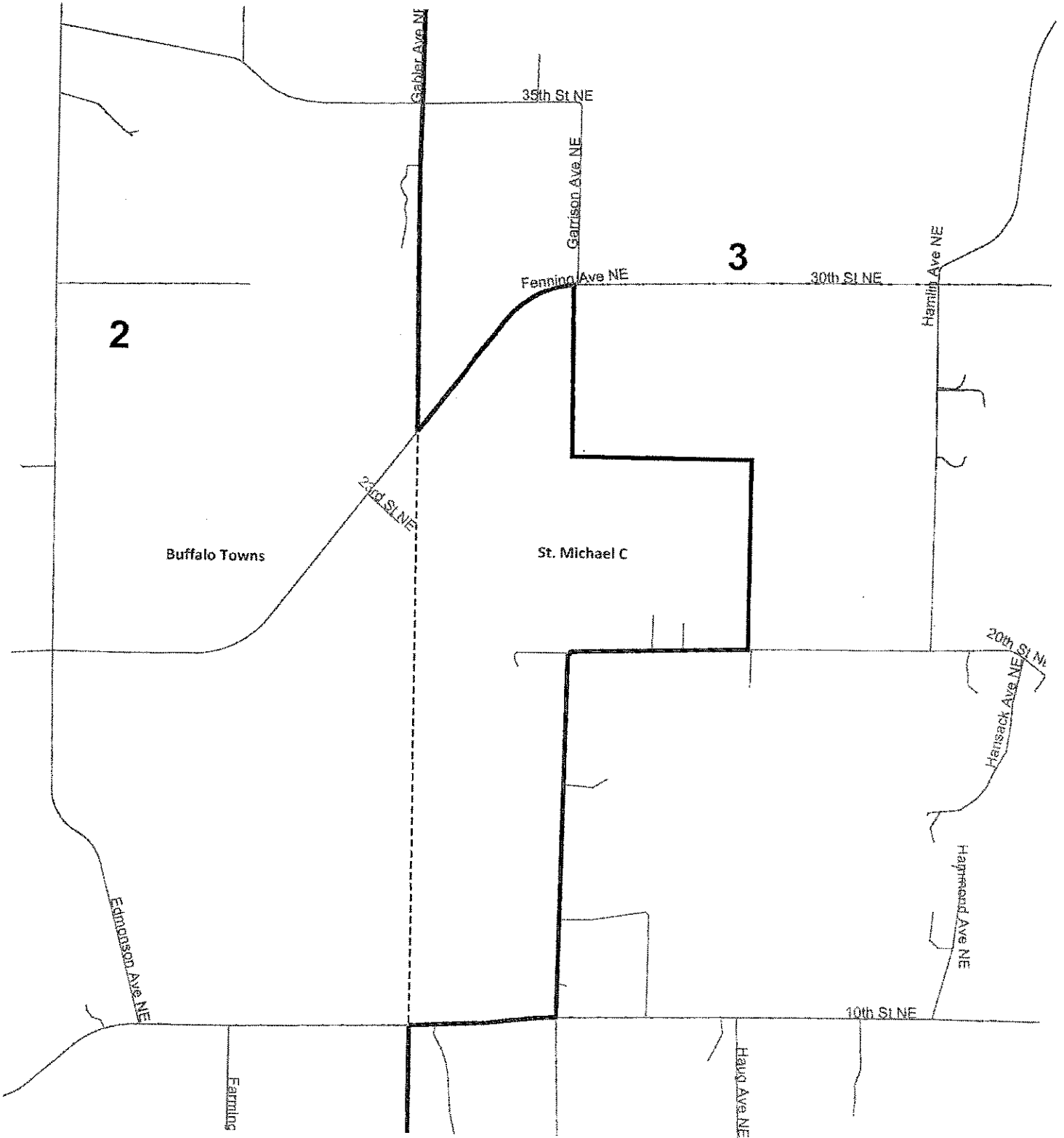

# Britton et al Congressional Plan Township Split - Northern (Beltrami)

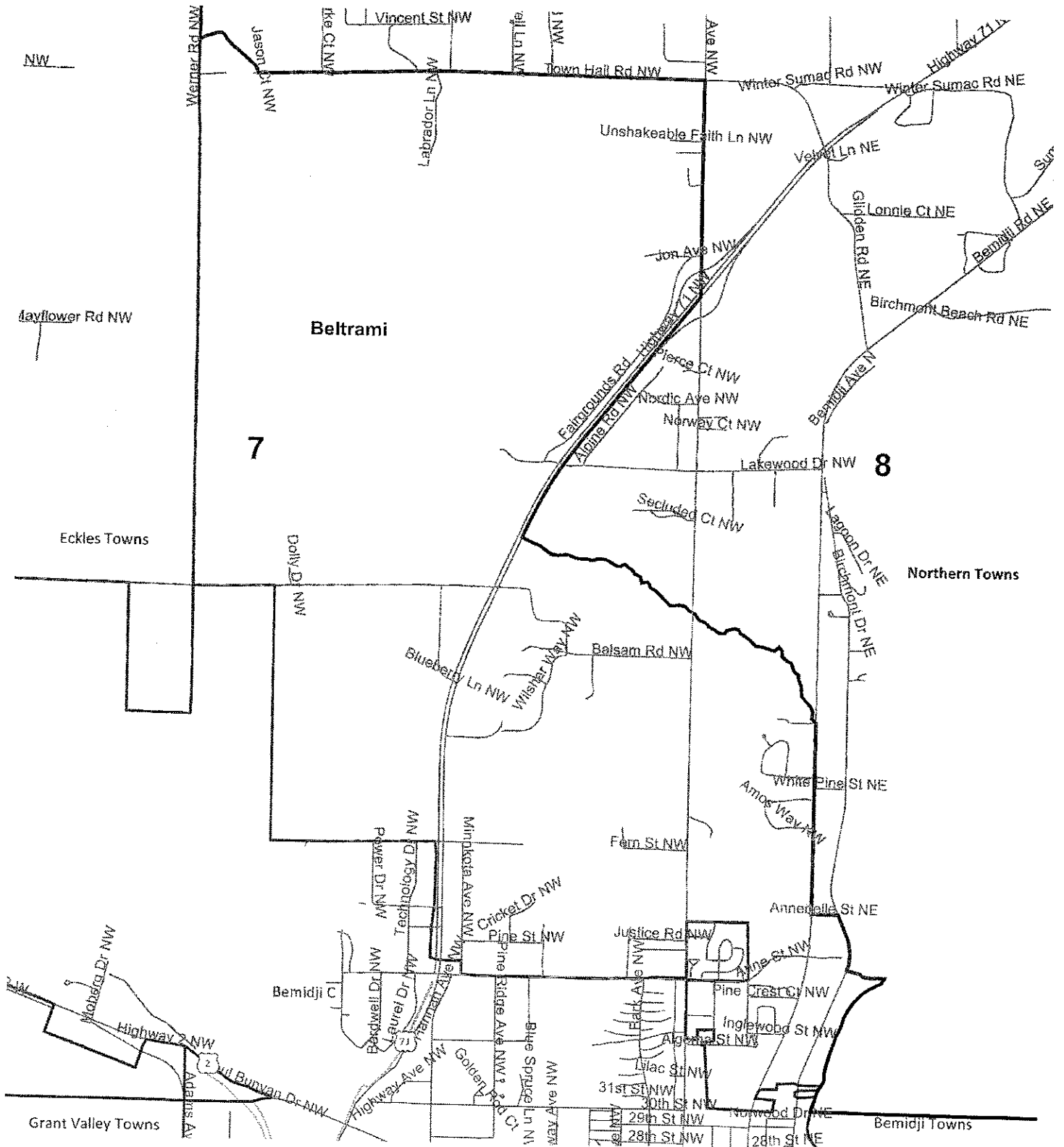

# Britton et al Congressional Plan Township Split - Rockford (Wright)

